

1 Ishikawa Industrial Exhibition Hall

193 Minami, Hukurobatake-machi, Kanazawa 920-0361
 TEL: 076-268-1121 FAX: 076-268-1153
 URL: <https://www.pref.ishikawa.lg.jp/tenjikan/index.html>



■ Number of seats
7,000 seats (Hall 4)



■ Traffic access
 25-min bus ride from JR Kanazawa Station (West exit)
 (Get off at Seibu Ryokuchi Koen-mae and walk for 5 min.)
 15 min by taxi from JR Kanazawa Station (West exit)



■ Hours
 9:00am~5:00pm (Rental time can be extended)
 Closed: Year-end and New Year's holidays
 (Dec. 29~Jan. 3)

■ Date to start accepting reservation
 Industrial events: One year before the date of use
 Other events: Six months before the date of use



■ Accommodation
 None



■ Restaurants/Cafés
 None



■ Parking
3,500 vehicles (free)



■ Remarks
 None

■ Convention site Hall 1

Site name	Floor	Area (㎡)	Width×Depth (m) (m)	Ceiling height (m)	Capacity (persons)				Remarks	
					Fixed seats	School	Theater	Seated		Buffet
Exhibition site	1	3,193	49.5×63.9	10.0	—	—	3,600	—	—	Load capacity: 1.5 t/㎡, air conditioned
Business meeting room 1	1	23	—	—	10	—	—	—	—	Air conditioned
Business meeting room 2	1	23	—	—	10	—	—	—	—	Air conditioned
Special meeting room	2	39	—	—	—	12	—	—	—	Table (3), Chair (12), air conditioned

Width × Depth and the floor area may differ depending on the shape of the room.

Floor plan

Hall 1

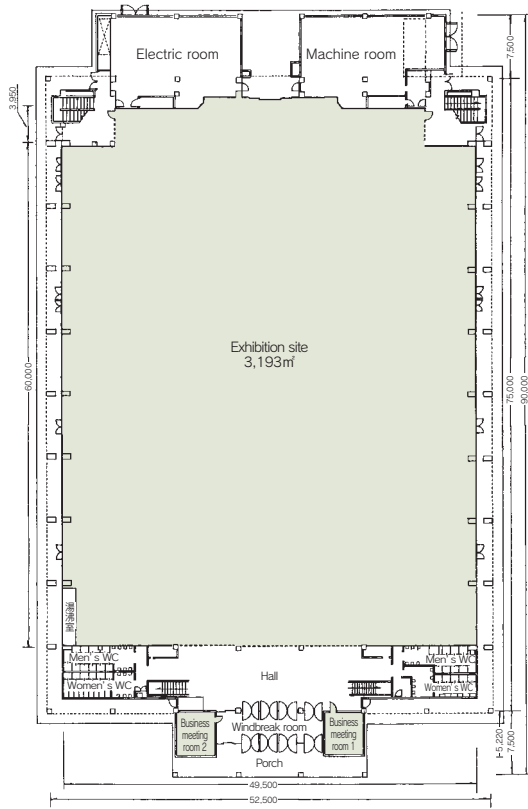

Hall 2

(1F)

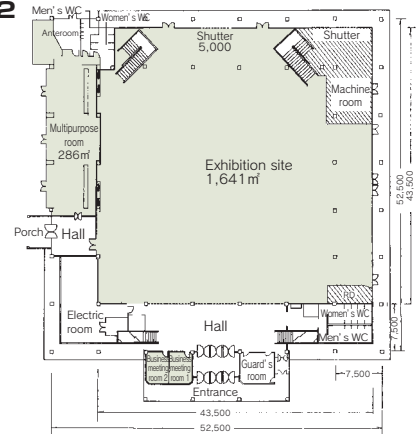

(2F)

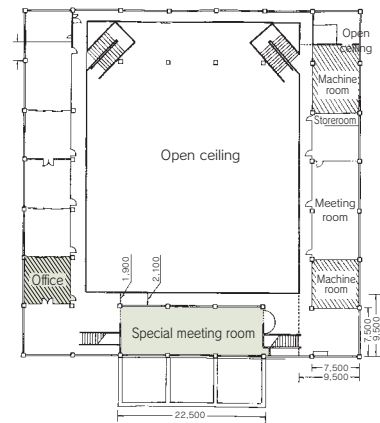

Convention site Hall 2

Site name	Floor	Area (m²)	Width×Depth (m) (m)	Ceiling height (m)	Capacity (persons)					Remarks
					Fixed seats	School	Theater	Seated	Buffet	
Exhibition site	1	1,641	43.5×43.5	10.0	—	—	1,900	—	—	Load capacity: 0.7t/m² ~ 1.5t/m², air-conditioned
Business meeting room 1	1	19	—	—	10	—	—	—	—	Air-conditioned
Business meeting room 2	1	19	—	—	10	—	—	—	—	Air-conditioned
Meeting room	2	78	—	—	—	—	42	—	—	Table 14, Chair 42, air-conditioned
Special meeting room	2	152	—	—	—	—	26	—	—	Table 13, Chair 26, air-conditioned
Multipurpose room	1	286	—	—	136	—	—	—	—	Table 25, Chair 136, air-conditioned

Width × Depth and the floor area may differ depending on the shape of the room.

Floor plan



Multipurpose room (Hall 2)



Special meeting room (Hall 3)

Hall 3

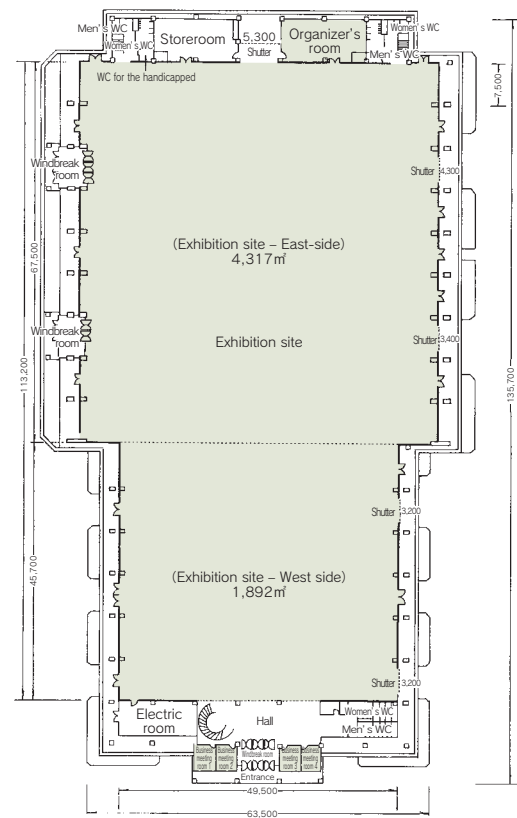

Convention site Hall 3

Site name	Floor	Area (m ²)	Width×Depth (m) (m)	Ceiling height (m)	Capacity (persons)					Remarks
					Fixed seats	School	Theater	Seated	Buffet	
Exhibition site (entire space)	1	6,209	—	—	—	—	7,000	—	—	
Exhibition site - East-side	1	4,317	63.5×67.5	15.5	—	—	4,800	—	—	Load capacity: 1.5t/m ² ~ 5.5t/m ² , air-conditioned
Exhibition site - West side	1	1,892	49.5×45.7	10.0	—	—	2,200	—	—	Load capacity: 1.5t/m ² ~ 5.5t/m ² , air-conditioned
Organizer's room	1	105	—	—	42	—	—	—	—	Table 14, Chair 42, air-conditioned
Business meeting room 1	1	19	—	—	10	—	—	—	—	Air-conditioned
Business meeting room 2	1	19	—	—	10	—	—	—	—	Air-conditioned
Business meeting room 3	1	19	—	—	10	—	—	—	—	Air-conditioned
Business meeting room 4	1	19	—	—	10	—	—	—	—	Air-conditioned
Meeting room	2	172	—	—	—	54	—	—	—	Table 22, Chair 54, air-conditioned
Special meeting room	2	56	—	—	—	12	—	—	—	Table 3, Chair 12, air-conditioned

Width × Depth and the floor area may differ depending on the shape of the room.

Floor plan

■ Hall 4 (1F)

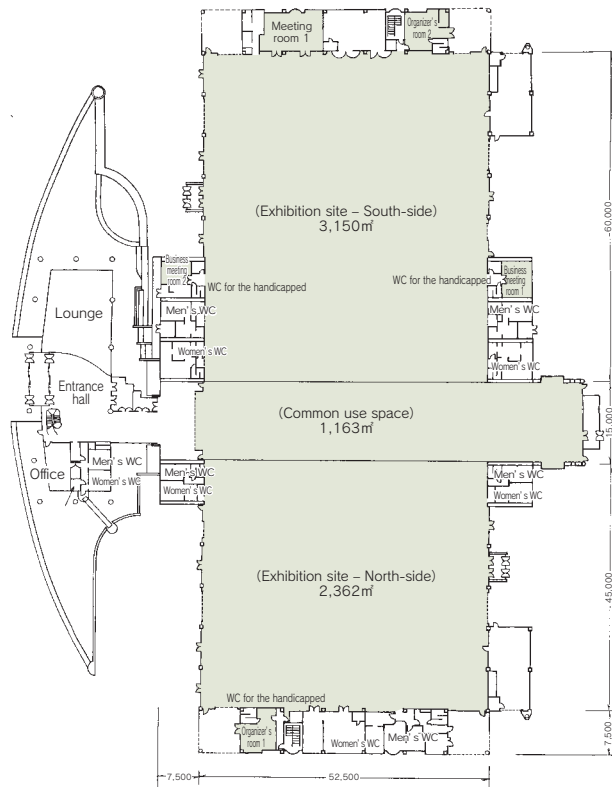

(2F)

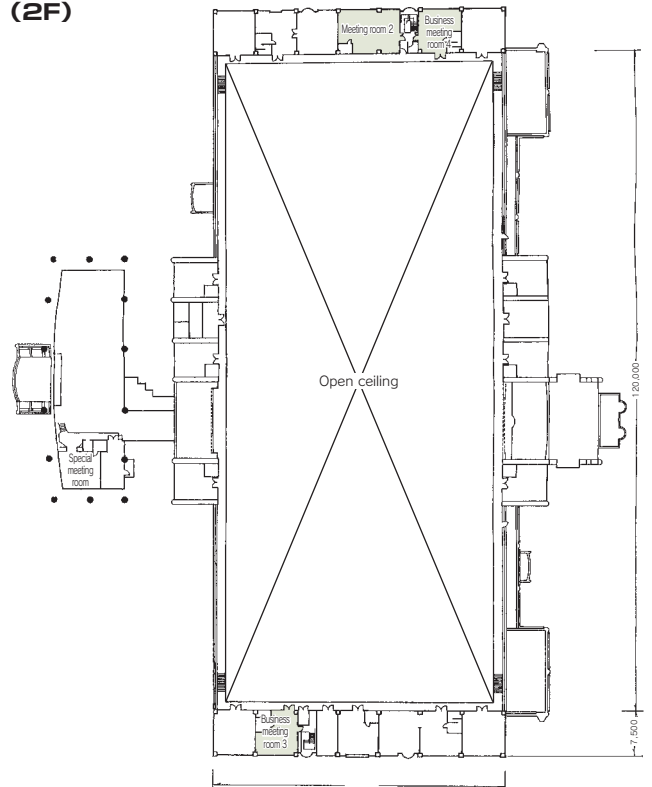

■ Convention site Hall 4

Site name	Floor	Area (m ²)	Width×Depth (m) (m)	Ceiling height (m)	Capacity (persons)					Remarks
					Fixed seats	School	Theater	Seated	Buffet	
Exhibition site - Entire room	1	6,675	—	8~19	—	—	7,000	—	—	Load capacity: 1.5t/m ² , air-conditioned
Exhibition site - North-side	1	2,362	45.0×52.5	8~19	—	—	2,500	—	—	Load capacity: 1.5t/m ² , air-conditioned
Exhibition site - South-side	1	3,150	60.0×52.5	8~19	—	—	3,500	—	—	Load capacity: 1.5t/m ² , air-conditioned
Exhibition site common use space	1	1,163	15.0×77.5	8~19	—	—	1,000	—	—	Load capacity: 1.5t/m ² , air-conditioned
Organizer's room 1	1	39	—	—	—	—	—	—	—	Air conditioned
Organizer's room 2	1	47	—	—	—	—	—	—	—	Air conditioned
Business meeting room 1	1	38	—	—	—	—	—	—	—	Air conditioned
Business meeting room 2	1	23	—	—	—	—	—	—	—	Air conditioned
Business meeting room 3	2	49	—	—	—	—	—	—	—	Air conditioned
Business meeting room 4	2	50	—	—	—	—	—	—	—	Air conditioned
Meeting room 1	1	75	—	—	—	—	—	—	—	Air conditioned
Meeting room 2	2	84	—	—	—	—	—	—	—	Air conditioned
Special meeting room	2	49	—	—	—	—	—	—	—	Table 2, Chair 10, air-conditioned

Width × Depth and the floor area may differ depending on the shape of the room.