

1 Kanazawa Bunka Hall

15-1 Takaoka-machi, Kanazawa 920-0864
 TEL: 076-223-1221 FAX: 076-223-1299
 URL: <https://www.bunka-h.gr.jp>



Concert Hall



Multipurpose room



■ Number of seats
899 seats (Hall) , Orchestra pit 59m²



■ Traffic access
 15-min bus ride from JR Kanazawa Station (Get off at Minami-cho/Oyama Shrine and walk for 3 min.)
 10 min by taxi from JR Kanazawa Station



■ Hours
 9:00am~10:00pm
 Closed: 2nd and 4th Wed. of the month
 (Days may change depending on events.)
 Year-end and New Year's holidays (Dec. 29~Jan. 3)

■ Date to start accepting reservation
 Beginning of the month one year before the date of use



■ Accommodation
 None



■ Restaurants/Cafés
 None



■ Parking
 None



■ Remarks
 Japanese Tearoom "Kansei-an"
 7 green rooms, 4 practice rooms
 Gallery

■ Convention site

Site name	Floor	Area (m ²)	Width×Depth (m)	Ceiling height (m)	Capacity (persons)					Remarks
					Fixed seats	School	Theater	Seated	Buffet	
Concert Hall	—	868	—	—	899	—	—	—	—	1st floor: 800 seats, 2nd-floor: 99 seats, 4 wheelchair spaces
Assembly Room (Entire space)	2	440	14.3×31.3	2.3~3.3	—	160	400	—	—	
Assembly Room (Area 1)	2	273	14.3×19.5	2.3~3.3	—	88	220	—	—	
Assembly Room (Area 2)	2	167	14.3×11.4	2.3~3.3	—	48	130	—	—	
Conference Room 1	2	31	5.2×6.0	2.6	12	—	—	—	—	Oval-shaped table
Conference Room 2	2	48	5.2×9.4	2.6	20	—	—	—	—	Oval-shaped table
Conference Room 3	3	31	5.2×6.0	2.4	—	14	—	—	—	
Conference Room 4	3	47	5.2×9.0	2.4	8	—	—	—	—	Lounge suite
Conference Room 5	3	64	5.6×11.4	2.4	—	30	—	—	—	Two rooms can be joined for use as one room.
Conference Room 6	3	64	5.6×11.4	2.4	—	30	—	—	—	
Large Conference Room (incl. Waiting Area)	3	350	—	2.8~3.8	—	99	210	—	—	
Lounge	3	36	5.5×6.5	2.4	12	—	—	—	—	Oval-shaped table
Japanese Tearoom	1	131	—	—	—	—	—	—	—	4.5-tatami-mat tearoom, 11-tatami-mat tearoom, chair seating tearoom
Gallery	1	300	—	2.6~3.1	—	—	—	—	—	
Multipurpose room	1	87	—	2.6	—	36	60	—	—	

Width × Depth and the floor area may differ depending on the shape of the room.

Floor plan

1F

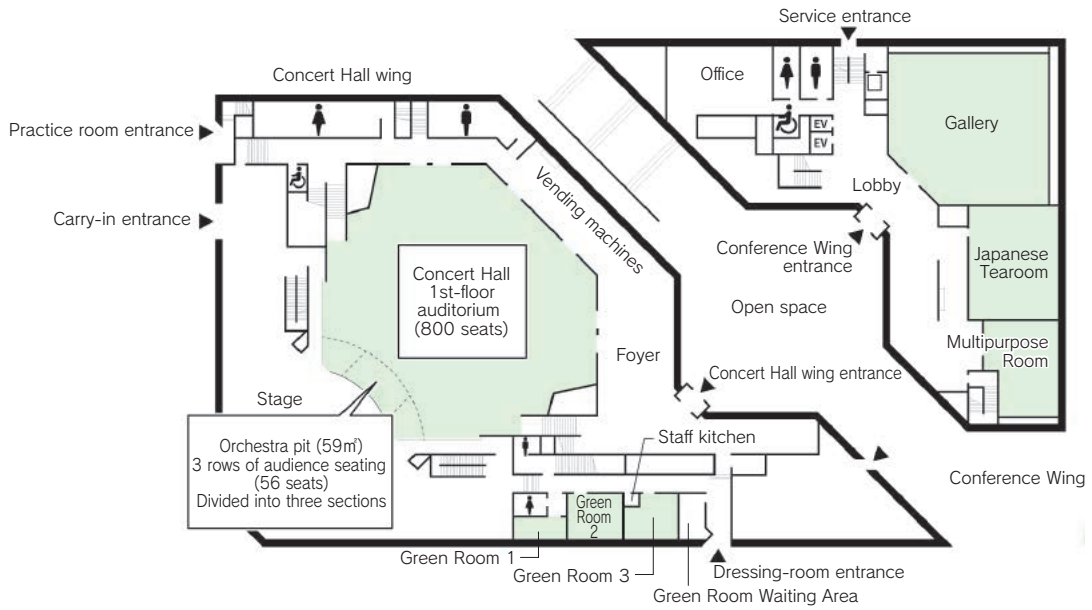

2F

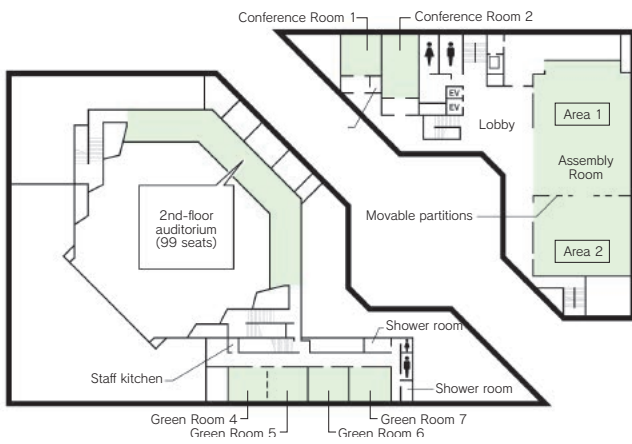

Assembly Room

3F

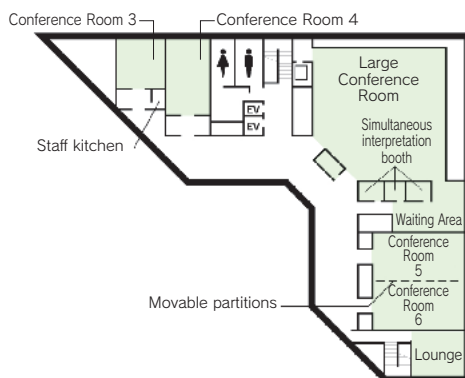

Large Conference Room