

English



Fukushoji Temple (Noto Town)

<https://www.kanazawa-cb.com>

KAGA·NOTO

Convention Facility Guide



Ukimido Hall, Katayamazu Hot Spring (Kaga City)

Convention Facility Map



| INDEX |

Kaga	
Nonoichi City	1 Nonoichi City Hall "forte"..... 2
Hakusan City	2 Grand Hotel Hakusan..... 3
	3 Tsurugi Synthesis Cultural Center "Crane" .. 4
	4 Matto Cultural Center "Pino" 5
Nomi City	5 Ishikawa High-Tech Conference Center 6
	6 Tatsunokuchi Onsen Tagawa Ryusenkaku 7
	7 Terai District Community Center 8
	8 Neagari Synthesis Cultural Center "Tanto" 9
Komatsu City	9 Komatsu URARA Theater 10 <small>(The name will be changed to "Komatsu Danjuro Arts Theater Urara" from March 4, 2023)</small>
	10 Komatsu City Public Hall..... 11
	11 Komatsu Civic Center 12
	12 Komatsu Chamber of Commerce and Industry Small and Medium Enterprises Seminar House..... 13
	13 Komatsu Dome 14
	14 Komatsu Hokuden Hall (temporary name) 15
	15 Science Hills Komatsu 16
	16 Manten-no Tsujinoya 17
	17 Route-Inn Grantia Komatsu Airport 18
Kaga City	18 Municipal Lyceum in Kaga "Come On a Hall"..... 19
	19 Katayamazuru Onsen Kasuikyo 20
	20 Hatori 21
	22 Hotel Arrowle..... 22
	22 Kaga Hyakumangoku..... 23
	23 Yamanaka Onsen Cultural Center 24
	24 Yamanaka-za 25
	25 Yunokuni Tensyo 26
	26 Rurikoh 27

Noto	
Suzu City	27 Suzu Beach Hotel 28
	28 La Porte Suzu 29
Noto Town	29 Concert Noto 30
Wajima City	30 Wajima City Cultural Center 31
Anamizu Town	31 Castle Manai 32
	32 Noto Fureai Cultural Center 33
Nanao City	33 Aenokaze 34
	34 Ishikawa Nanao Art Museum 35
	35 Kagaya 36
	36 Nanao Sunlife Plaza 37
	37 Nanao Nakajima Cultural Center, Noto Engekido Theater 38
	38 Notoraku 39
	39 Forum Nanao 40
	40 Yadomoriya Jyuen 41
	41 Wakura Onsen Omatsuri Hall 42
Nakanoto Town	42 Traditional house, Mioya-no-sato 43
Shika Town	43 Ikoi no Mura Noto Hanto 44
	44 Shika Town Togi Regional Development Center 45
	45 Royal Hotel Noto 46
Hakui City	46 Space Science Museum "Cosmo Isle Hakui" 47
Kahoku City	47 AMANDAN VILLA 48
	48 Ishikawa NISHIDA KITARO Museum of Philosophy 49
Tsubata Town	49 Tsubata Town Cultural Center "CYGNUS" 50
Uchinada Town	50 Uchinada Town Cultural Center 51

Legend

● Facility name

● Inquiries/ Reservation

■ Number of seats: The number of seats (fixed seating) in the largest room is indicated. If there are no fixed seats, the capacity in the theater style and the room names are indicated.

■ Traffic access: Required time by bus or taxi from JR Kanazawa Station or the nearest station.

■ Date to start accepting reservation: Date to start accepting general reservation

■ Please ask the Kanazawa Convention Bureau for advance reservation for national-scale conventions.

■ Accommodation: Number of rooms by room type and the total capacity are indicated.

■ Restaurants/ Cafés: Name and the number of seats are indicated.

■ Parking: Capacity and whether fees are charged or not are indicated. There may be a discount for parking fees. Please ask the facility for the details.

● Convention site

□ Width × Depth: Effective width and depth of the room

*There may be difference between the width × depth and the area depending on the room shape.

□ School: Capacity in the school style (with desks and chairs)

□ Theater: Capacity in the theater style with chairs only

□ Seated: Capacity when guests are seated for dining

□ Buffet: Capacity for a stand-up style party

Nonoichi City Hall "forte"

5-4-1 Hon-machi, Nonoichi 921-8815
TEL: 076-248-8000 FAX: 076-246-2391
URL: <http://forte.nono1.jp>
E-mail: info@forte.nono1.jp

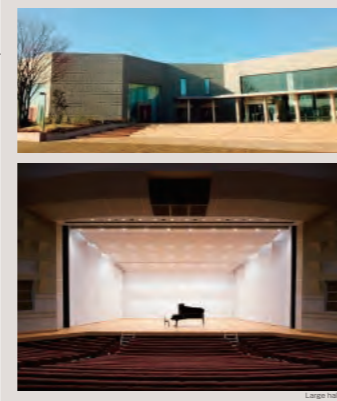

- Number of seats
804 seats (Large hall)
- Traffic access
30 min by bus from JR Kanazawa Station (Get off at Taheriji and walk for 2 min.)
20 min by taxi from JR Kanazawa Station
- Hours
9:00am~10:00pm
Closed: 1st and 3rd Wed., year-end and New Year's holidays (Dec. 28~Jan. 3)
- Date to start accepting reservation
Beginning of the month one year before the date of use
- Accommodation
None
- Restaurants/Cafés
Coffee shop "forte HIMAWARI": 20 seats
- Parking
250 vehicles (free)
- Remarks
Dressing room: 3, Rehearsal room: 1

Floor plan

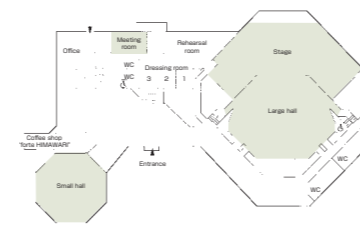

Site name	Floor	Area(m ²)	Width × Depth (m)	Ceiling height(m)	Capacity (persons)					Remarks
					Fixed seats	School	Theater	Seated	Buffet	
Large hall	1	700	—	—	804	—	—	—	—	1F: 682 seats, 2F: 122 seats
Small hall	1	326	—	5.3	—	150	300	—	—	
Meeting room	1	57	10.0 × 5.2	2.7	—	20	—	—	—	
Culture room	2	121	15.0 × 7.5	2.7	—	48	—	—	—	
Lecture room	2	56	7.5 × 7.5	2.7	—	20	—	—	—	
Japanese-style room	2	36 tatami-mat	10.2 × 5.0	2.5	—	—	—	—	—	Two tatami-mat rooms adjacent to a tea-ceremony room (6 tatami-mat)
Seminar room	2	60	7.5 × 8.0	2.7	—	25	—	—	—	
Conference room	2	36	3.8 × 8.0	2.7	—	12	—	—	—	

Width × Depth and the floor area may not match depending on the shape of the room.

Nonoichi City Hall "forte"

5-4-1 Hon-machi, Nonoichi 921-8815
TEL: 076-248-8000 FAX: 076-246-2391
URL: <http://forte.nono1.jp>
E-mail: info@forte.nono1.jp



■ Number of seats
804 seats (Large hall)

■ Traffic access
30 min by bus from JR Kanazawa Station (Get off at Taheriji and walk for 2 min.)
20 min by taxi from JR Kanazawa Station

■ Hours
9:00am~10:00pm
Closed: 1st and 3rd Wed., year-end and New Year's holidays (Dec. 28~Jan. 3)

■ Date to start accepting reservation
Beginning of the month one year before the date of use

■ Accommodation
None

■ Restaurants/Cafés
Coffee shop "forte HIMAWARI": 20 seats

■ Parking
250 vehicles (free)

■ Remarks
Dressing room: 3, Rehearsal room: 1

Floor plan

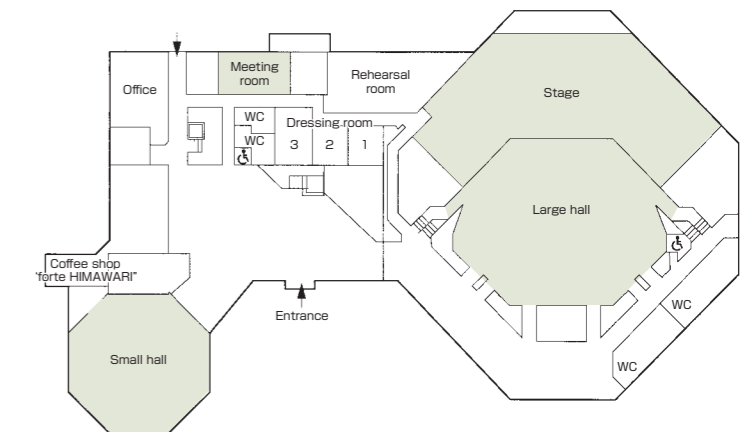

■ Convention site

Site name	Floor	Area(m ²)	Width × Depth (m)	Ceiling height(m)	Capacity (persons)					Remarks
					Fixed seats	School	Theater	Seated	Buffet	
Large hall	1	700	—	—	804	—	—	—	—	1F: 682 seats, 2F: 122 seats
Small hall	1	326	—	5.3	—	150	300	—	—	
Meeting room	1	57	10.0 × 5.2	2.7	—	20	—	—	—	
Culture room	2	121	15.0 × 7.5	2.7	—	48	—	—	—	
Lecture room	2	56	7.5 × 7.5	2.7	—	20	—	—	—	
Japanese-style room	2	36 tatami-mat	10.2 × 5.0	2.5	—	—	—	—	—	Two tatami-mat rooms adjacent to a tea-ceremony room (6 tatami-mat)
Seminar room	2	60	7.5 × 8.0	2.7	—	25	—	—	—	
Conference room	2	36	3.8 × 8.0	2.7	—	12	—	—	—	

Width × Depth and the floor area may not match depending on the shape of the room.

Grand Hotel Hakusan

152-7 Nishishin-machi, Hakusan 924-0871
 TEL: 076-274-0001 FAX: 076-274-3300
 URL: <http://www.grandhotel-hakusan.jp/>
 E-mail: info@ghaku.jp



Large banquet room "Glory Hall"

Floor plan

■ 2F

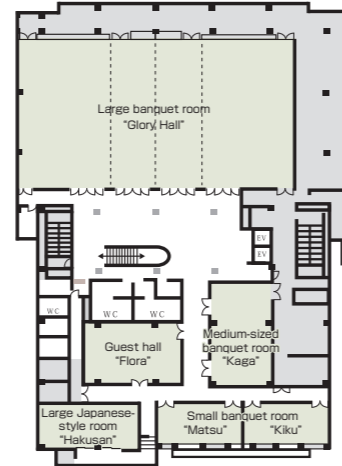

■ Number of seats
300 seats (Large banquet room "Glory Hall")



■ Traffic access
 3-min walk from JR Matto Station
 10 min by train from JR Kanazawa Station



■ Hours
 8:00am~10:00pm

■ Date to start accepting reservation
 At any time



■ Accommodation
 • Single room
 Main building: 37
 Annex: 50
 • Twin room: 20
 • Double room: 10
 • Suite: 1



■ Restaurants/Cafés
 Japanese restaurant "Chiyo": 80 seats



■ Parking
100 vehicles (500 yen/night if lodging)
 Other affiliated parking lots are available.
 * Free with conditions



■ Remarks
 • Large bathroom (Lodgers are free)
 • Coin laundry (pay)

■ Convention site

Site name	Floor	Area(m ²)	Width × Depth (m) (m)	Ceiling height(m)	Capacity (persons)				Remarks	
					Fixed seats	School	Theater	Seated		Buffet
Large banquet room All	All	576		5.8	—	300	420	300	500	
	2/3	385		5.8	—	200	300	180	300	
	1/2	284		5.8	—	140	200	140	200	
	1/3	191		5.8	—	90	100	80	80	
Medium-sized banquet room "Kaga"	2	94		3.0	—	40	60	35	50	
Guest hall "Flora"	2	92		3.0	—	40	60	35	50	
Large Japanese-style room "Hakusan"	2	58		2.7	—	—	—	26	—	
Small banquet room "Matsu", "Kiku"	2	49		3.0	—	20	30	20	20	

Width × Depth and the floor area may not match depending on the shape of the room.

Tsurugi Synthesis Cultural Center "Crane"

77 Shichihara-machi, Hakusan 920-2143
 TEL: 076-273-8700 FAX: 076-273-8701
 E-mail: cranehall@city.hakusan.ishikawa.jp



Culture hall



■ Number of seats
805 seats (Culture hall)
 (General seat: 798, Wheelchair space: 7)



■ Traffic access
 50 min by bus from JR Kanazawa Station for Shimomorishima (Get off at Shichihara and walk for 2 min.)
 Hokuriku Railroad Ishikawa Line (Get off at Dohoji and walk for 30 min.)



■ Hours
 9:00am~10:00pm
 Closed: Monday (the following weekday when Monday is a holiday), Year-end and New Year's holidays (Dec. 27~Jan. 4)

■ Date to start accepting reservation
 Culture hall and related facilities: one year before
 Lifelong learning area (Workshop rooms): three months before



■ Accommodation
 None



■ Restaurants/Cafés
 Coffee shop "Gion": 35 seats



■ Parking
400 vehicles (free)



■ Remarks
 None

Floor plan

■ 1F

■ 2F

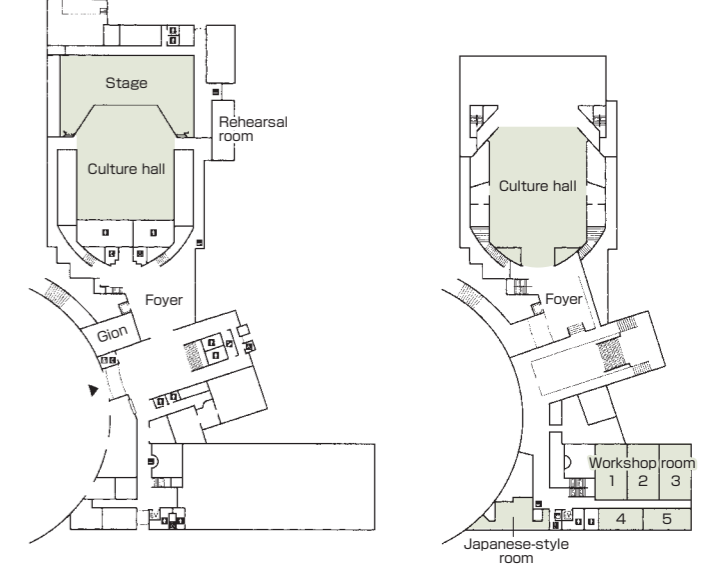

■ Convention site

Site name	Floor	Area(m ²)	Width × Depth (m) (m)	Ceiling height(m)	Capacity (persons)					Remarks
					Fixed seats	School	Theater	Seated	Buffet	
Culture hall	1	—	—	—	805	—	—	—	—	Wheelchair space: 7
Workshop room1	2	100	7.5 × 13.0	4	—	60	—	—	—	Workshop room 1 ~ 3 can be integrated into one space.
Workshop room2	2	100	7.5 × 13.0	4	—	60	—	—	—	
Workshop room3	2	100	7.5 × 13.0	4	—	60	—	—	—	
Workshop room4	2	55	11.0 × 5.0	4	—	30	—	—	—	
Workshop room5	2	55	11.0 × 5.0	4	20	—	—	—	—	
Japanese-style room	2	25-tatami-mat	9.0 × 5.0	2	—	—	—	—	—	

Width × Depth and the floor area may not match depending on the shape of the room.

Matto Cultural Center "Pino"

2 Furushiro-machi, Hakusan 924-0872
 TEL: 076-276-5611 FAX: 076-276-5612
 E-mail: hcsk-bunka@city.hakusan.ishikawa.jp



Large hall

Floor plan

■ 1F



■ Number of seats
1,186 seats (Large hall)



■ Traffic access
 5-min walk from JR Matto Station



■ Hours
 9:00am~10:00pm
 Closed: Monday (the following weekday when Monday is a holiday), year-end and New Year's holidays (Dec. 29~Jan. 3)

■ Date to start accepting reservation
 Beginning of the month one year before the date of use



■ Accommodation
 None



■ Restaurants/Cafés
 Coffee shop "Chacha": 20 seats



■ Parking
 65 vehicles (free)



■ Remarks
 None

■ Convention site

Site name	Floor	Area(m ²)	Width × Depth (m)	Ceiling height(m)	Capacity (persons)					Remarks
					Fixed seats	School	Theater	Seated	Buffet	
Large hall	1・2	-	-	-	1,186	-	-	-	-	1F: 672 seats, 2F: 514 seats
Workshop room 301	3	50	6.3 × 8.0	2.4	-	30	-	-	-	
Workshop room 302	3	50	6.3 × 8.0	2.4	-	30	-	-	-	
Workshop room 303	3	50	6.3 × 8.0	2.4	-	30	-	-	-	
Workshop room 304	3	88	12.6 × 7.0	2.4	-	45	-	-	-	
Workshop room 401	4	151	18.9 × 8.0	2.4	-	110	-	-	-	
Multipurpose room	2	190	18.0 × 11.4	3.3	-	90	-	-	-	

Width × Depth and the floor area may not match depending on the shape of the room.

Ishikawa High-Tech Conference Center

2-1 Asahidai, Nomi 923-1211
 TEL: 0761-51-0106 FAX: 0761-51-0161
 URL: www.isico.or.jp/isp
 E-mail: office@ishikawa-sp.com



Large conference hall

Floor plan

■ 1F

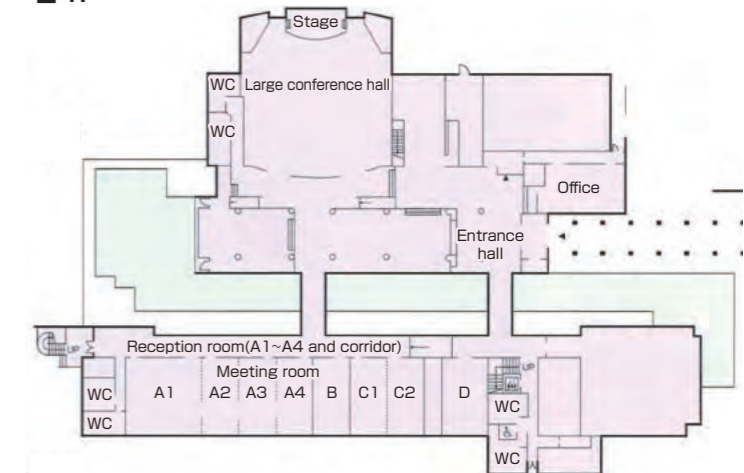

■ Number of seats
220 seats (Large conference hall)



■ Traffic access
 <From Komatsu Airport>
 ・30 min by taxi
 * People related to JAIST can take a shuttle bus at Komatsu Station by reservation.
 <From Kanazawa>
 ・Take a train at JR Kanazawa Station and get off at Nishi-Kanazawa Station. Change trains to the Ishikawa Line of Hokuriku Railroad, get off at Tsurugi Station and take a taxi (10 min ride).



■ Hours
 9:00am~9:00pm
 Closed: National holidays, year-end and New Year's holidays (Dec. 29~Jan. 3)

■ Date to start accepting reservation
 One year before the date of use



■ Accommodation
 ・Single room: 4
 ・Twin room: 4



■ Restaurants/Cafés
 None



■ Parking
 100 vehicles (free)



■ Remarks
 Tennis court: 2
 Wireless LAN accessible

■ Convention site

Site name	Floor	Area(m ²)	Width × Depth (m)	Ceiling height(m)	Capacity (persons)					Remarks
					Fixed seats	School	Theater	Seated	Buffet	
Large conference hall	1	433			220	-	-	-	-	LC projector, acoustic system
Meeting room A1	1	93				36				LC projector, acoustic system, screen, movable stage, gold-leafed folding screen ・ A1 ~ A4 can be integrated. ・ C1 ~ C2 can be integrated.
Meeting room A2	1	47				12				
Meeting room A3	1	47				12				
Meeting room A4	1	47				12				
Meeting room B	1	47				12				
Meeting room C1	1	47				12				
Meeting room C2	1	47				12				
Meeting room D	1	56			8	-				
Reception room (A1 ~ A4 and corridor)	1	304						150		

Width × Depth and the floor area may not match depending on the shape of the room.

Tatsunokuchi Onsen Tagawa Ryusenkaku

20 Tatsunokuchi-machi, Nomi 923-1245
 TEL: 0761-51-2111 FAX: 0761-51-3107
 URL: <http://www.ryusenkaku.com/>



Asuka







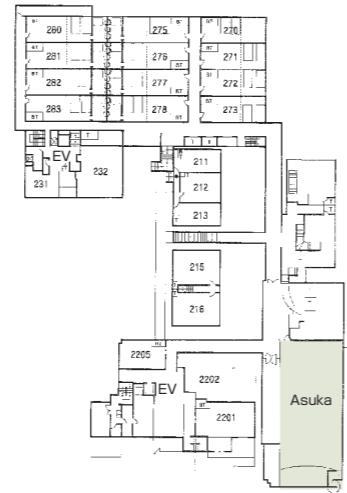

Tanbo-no-yu

Floor plan

■ 2F



-  ■ Number of seats
200 seats (Convention hall "Asuka" in school style)
-  ■ Traffic access
20 min by free pickup bus from JR Komatsu Station or JR Matto Station
(Reservation required: two or more people)
JR Komatsu Station: 2:10pm, 3:10pm, 4:15pm, 5:40pm
JR Matto Station: 3:15pm, 4:30pm, 5:30pm
-  ■ Hours
■ Date to start accepting reservation
One year before the date of use
-  ■ Accommodation
• Japanese-style room: 40 (3 rooms with an open-air bath)
• Japanese/Western-style room: 12 (8 rooms with an open-air bath)
Total: 52 rooms (326 people)
-  ■ Restaurants/Cafés
Club "Hana-to-Cho"
-  ■ Parking
100 vehicles
-  ■ Remarks
You can enjoy a variety of hot springs including the largest open-air bath in the Hokuriku region "Tanbo-no-yu". This area is close to the traditional city Kanazawa and has good access to golf courses.

■ Convention site

Site name	Floor	Area(m ²)	Width × Depth (m)	Ceiling height(m)	Capacity (persons)				Remarks
					Fixed seats	School	Theater	Seated	
Asuka	2	250	11 × 22.8	2.9		200			The space can be partitioned into two rooms.

Width × Depth and the floor area may not match depending on the shape of the room.







Terai District Community Center

Yo-47 Terai-machi, Nomi 923-1121
 TEL: 0761-57-0030 FAX: 0761-57-3709



Large hall

Floor plan

-  ■ Number of seats
500 seats (Large hall)
-  ■ Traffic access
1 hr by bus from JR Kanazawa Station
(Get off at Nomi Shiyakusho Terai Bunshitsu-mae and walk for 1 min.)
-  ■ Hours
9:00am~9:30pm
Closed: Monday, year-end and New Year's holidays (Dec. 28~Jan. 3)
■ Date to start accepting reservation
At any time
-  ■ Accommodation
None
-  ■ Restaurants/Cafés
Coffee shop "Coco": 17 seats
-  ■ Parking
245 vehicles (free)
The 133 vehicle parking lot is shared with Terai Gymnasium.
The 89 vehicle parking lot is not used during the weekday daytime.
-  ■ Remarks
None

■ 1F

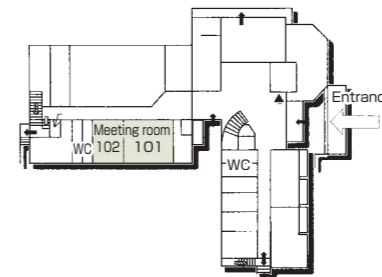

■ 2F

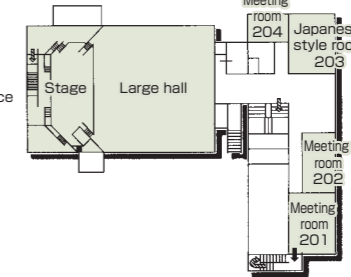

■ 3F

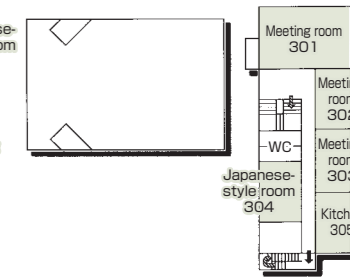

■ Convention site

Site name	Floor	Area(m ²)	Width × Depth (m)	Ceiling height(m)	Capacity (persons)				Remarks	
					Fixed seats	School	Theater	Seated		Buffet
Meeting room 101	1	83.0			-	36	-	-	-	
Meeting room 102	1	49.8			-	24	-	-	-	
Meeting room 201	2	80.0			-	20	-	-	-	
Meeting room 202	2	58.0			-	24	-	-	-	
Japanese-style room 203	2	40-tatami-mat			-	-	-	-	-	
Meeting room 204	2	35.0			-	18	-	-	-	
Large hall	2	451.5			-	120	500	-	-	
Meeting room 301	3	150.0			-	36	64	-	-	
Meeting room 302	3	58.0			-	24	-	-	-	
Meeting room 303	3	58.0			-	30	-	-	-	
Japanese-style room 304	3	25-tatami-mat			-	-	-	-	-	
Kitchen 305	3	58.0			-	30	-	-	-	

Width × Depth and the floor area may not match depending on the shape of the room.

Neagari Synthesis Cultural Center "Tanto"

Nu-118 Taisei-machi, Nomi 929-0113
 TEL: 0761-55-8550 FAX: 0761-55-8555
 URL: <http://www.city.nomi.ishikawa.jp/>
 E-mail: manabi@city.nomi.lg.jp



Floor plan

■ 1F

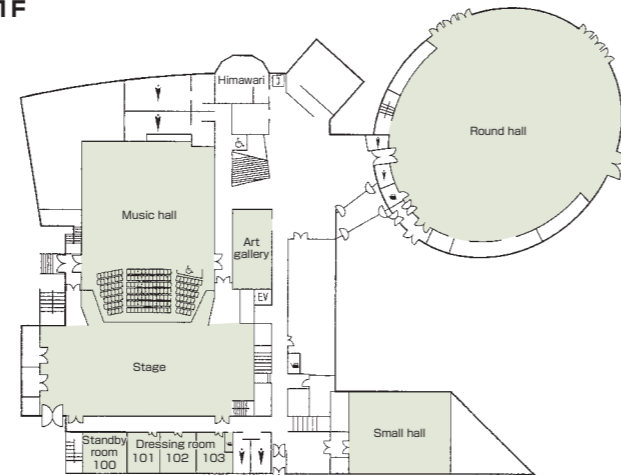

■ Number of seats
704 seats (Music hall)
 (Fixed seat: 632, Balcony seat: 60,
 Wheelchair space: 2, Parent and child seat: 10)



■ Traffic access
 5-min walk from JR Nomi-Neagari Station
 5-min drive from Nomi-Neagari IC of Hokuriku Expressway
 8-min drive from Komatsu IC of Hokuriku Expressway



■ Hours
 9:00am~10:00pm
 Closed: Tuesday, year-end and New Year's holidays
 (Dec. 28~Jan. 3)

■ Date to start accepting reservation
 Music hall and round hall: Beginning of the month
 one year before the date of use
 Other facilities: Beginning of the month three months
 before the date of use



■ Accommodation
 None



■ Restaurants/Cafés
 Coffee shop "Himawari": 18 seats



■ Parking
300 vehicles (free)



■ Remarks
 Lunch boxes can be prepared by the coffee shop
 (reservation required)
 Coffee shop: TEL: 0761-55-8558

■ Convention site

Site name	Floor	Area(m ²)	Width × Depth (m)	Ceiling height(m)	Capacity (persons)					Remarks
					Fixed seats	School	Theater	Seated	Buffet	
Music hall	1,2	-	-	12.0	704	-	-	-	-	
Round hall	1	892	-	9.0	-	-	-	500	800	
Small hall	1	182	15.4 × 11.8	3.1	-	80	150	80	100	
Standby room 100	1	37	6.2 × 5.9	2.6	-	-	-	-	-	
Dressing room 101	1	35	6.2 × 4.8	2.4	-	-	-	-	-	
Dressing room 102	1	32	6.2 × 5.1	2.6	-	-	-	-	-	102 and 103 can be integrated into one space.
Dressing room 103	1	31	6.2 × 4.1	2.6	-	-	-	-	-	
Art gallery	1	61	11.0 × 5.4	4.4	-	-	-	-	-	
Meeting room 201	2	61	8.7 × 7.0	2.7	-	30	30	-	-	
Meeting room 202	2	72	10.3 × 7.0	2.7	25	-	-	-	-	
Chorus room 203	2	53	8.9 × 5.9	2.6	-	30	30	-	-	
Workshop room 204	2	92	8.4 × 10.9	2.6	-	60	60	-	-	

Width × Depth and the floor area may not match depending on the shape of the room.

Komatsu URARA Theater

(The name will be changed to "Komatsu Danjuro Arts Theater Urara" from March 4, 2023)
 710 Doihara-machi, Komatsu 923-0921
 TEL: 0761-20-5500 FAX: 0761-24-2481
 URL: www.komatsu-urara.com
 E-mail: urara@tvk.ne.jp

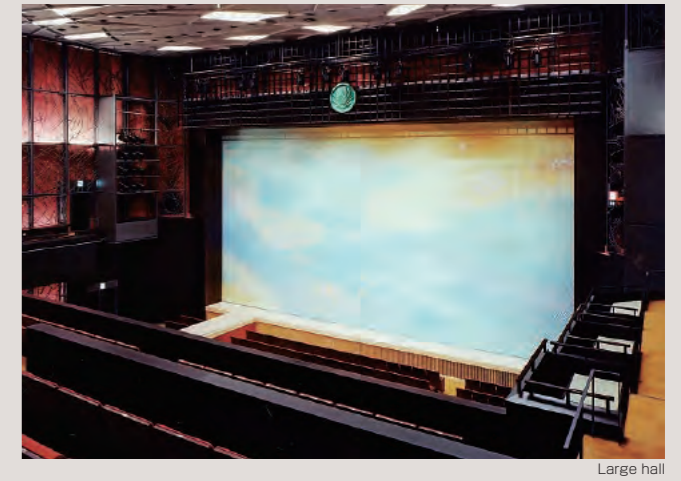

Floor plan

■ 1F

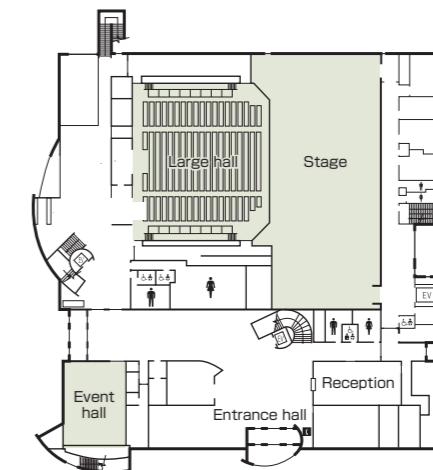

■ 2F

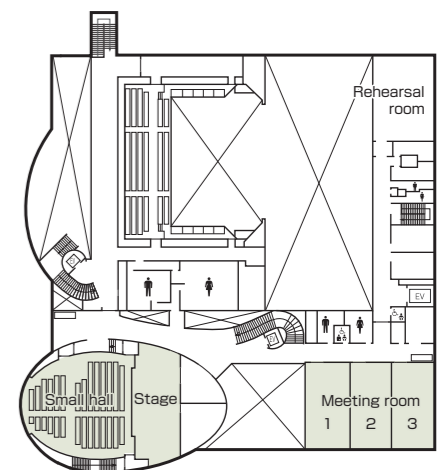

■ Number of seats
851 seats



■ Traffic access
 1-min walk from JR Komatsu Station
 12 min by bus from Komatsu Airport for Komatsu Station



■ Hours
 9:00am~10:00pm
 Closed: Wednesday

■ Date to start accepting reservation
 Hall: Beginning of the month one year before the date of use
 Meeting room: Beginning of the month six months before the date of use



■ Accommodation
 None



■ Restaurants/Cafés
 None



■ Parking
 None



■ Remarks
 Rehearsal room: 1

■ Convention site

Site name	Floor	Area(m ²)	Width × Depth (m)	Ceiling height(m)	Capacity (persons)					Remarks
					Fixed seats	School	Theater	Seated	Buffet	
Large hall	1	-	17.1 × 15.7	-	851	-	-	-	-	1F: 611 seats, 2F: 240 seats. Dressing room: 6
Small hall	2	-	10.5 × 6	-	250	-	-	-	-	Dressing room: 1
Meeting room	2	224	-	-	-	100	200	-	-	The space can be partitioned into two or three rooms.
Event hall	1	107	-	-	-	45	-	-	-	

Width × Depth and the floor area may not match depending on the shape of the room.

Komatsu City Public Hall

32 Marunouchikoen-machi, Komatsu 923-0903
 TEL: 0761-22-3141 FAX: 0761-22-3140
 E-mail: koukaidou@city.komatsu.lg.jp

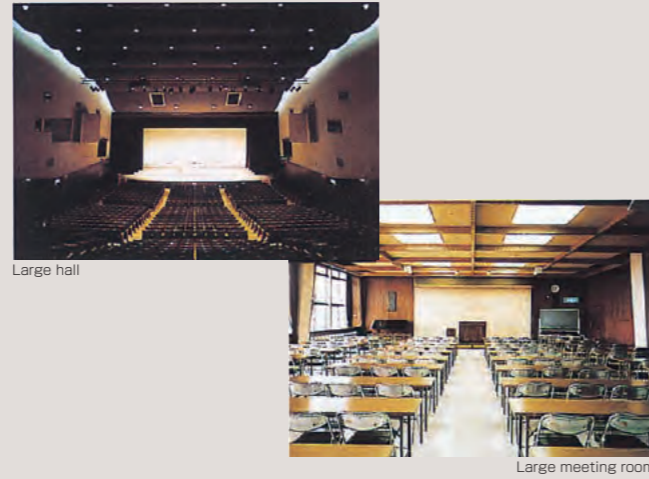

Floor plan

■ 2F

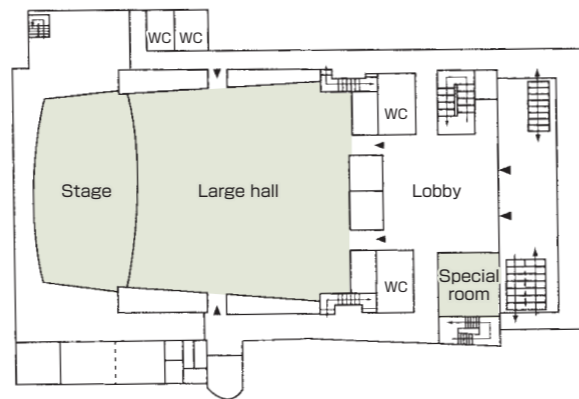

■ Number of seats
1,078 seats (Large hall)



■ Traffic access
 5 min by taxi from JR Komatsu Station
 15-min walk from JR Komatsu Station
 10 min by taxi from Komatsu IC
 10 min by taxi from Komatsu Airport



■ Hours
 9:00am~10:00pm
 Closed: Year-end and New Year's holidays (Dec. 29~Jan. 3)

■ Date to start accepting reservation
 Large hall: One year before the date of use
 Meeting room: three months before the date of use



■ Accommodation
 None



■ Restaurants/Cafés
 None



■ Parking
 None
 City Hall parking lot (free)



■ Remarks
 None

■ Convention site

Site name	Floor	Area(m ²)	Width × Depth (m)	Ceiling height(m)	Capacity (persons)					Remarks
					Fixed seats	School	Theater	Seated	Buffet	
Meeting room 1	1	72	12.0 × 6.0	2.8	-	24	-	-	-	
Meeting room 2	1	72	12.0 × 6.0	2.8	-	24	-	-	-	
Tea ceremony room	1	26	10.0 × 6.0	2.6	-	8	-	-	-	
Japanese-style room	1	35-tatami-mat	10.0 × 5.0	2.7	-	10	-	-	-	
Large hall	2	660	-	-	1,078	-	-	-	-	
Special room	2	36	6.0 × 6.0	2.4	10	-	-	-	-	
Meeting room 5	3	60	10.0 × 6.0	3.3	-	20	-	-	-	
Meeting room 6	3	60	10.0 × 6.0	3.3	-	20	-	-	-	
Meeting room 7	3	60	10.0 × 6.0	3.3	-	20	-	-	-	
Large meeting room	4	199	18.0 × 12.0	3.4	-	66	-	-	-	

Width × Depth and the floor area may not match depending on the shape of the room.

Komatsu Civic Center

Hei-42-3 Oshima-machi, Komatsu 923-0001
 TEL: 0761-24-6101 FAX: 0761-23-5811
 E-mail: siminsenta@city.komatsu.lg.jp



Floor plan

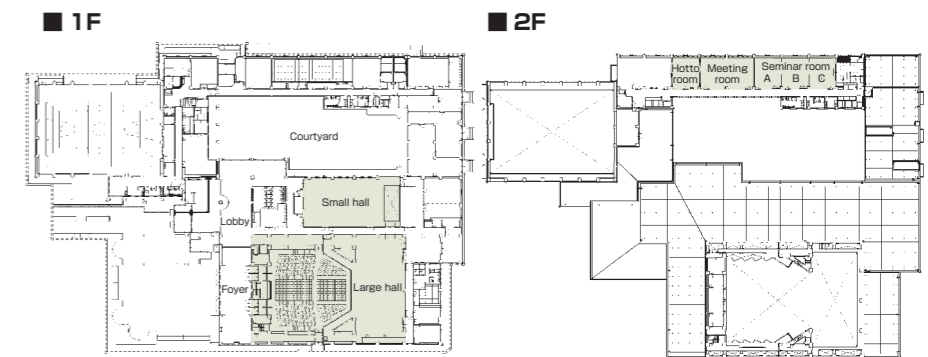

■ Number of seats
546 seats (Large hall)
 (Parent and child seats are provided.)



■ Traffic access
 4-min drive from Komatsu IC of Hokuriku Expressway
 8 min by taxi from JR Komatsu Station
 10 min by taxi from Komatsu Airport



■ Hours
 9:00am~10:00pm
 Closed: Monday (the following weekday when Monday is a holiday), year-end and New Year's holidays (Dec. 29~Jan. 3)

■ Date to start accepting reservation
 Large & Small halls: Beginning of the month one year before the date of use
 Other facility : Beginning of the month three months before the date of use



■ Accommodation
 None



■ Restaurants/Cafés
 None



■ Parking
 300 vehicles



■ Remarks
 No smoking (incl. parking lot)

■ Convention site

Site name	Floor	Area(m ²)	Width × Depth (m)	Ceiling height(m)	Capacity (persons)					Remarks
					Fixed seats	School	Theater	Seated	Buffet	
Large hall	1	852	-	-	546	-	-	-	-	(with parent and child seats)
Small hall	1	350	14.0 × 25.0	6.0	-	240	350	-	-	
Meeting room	2	126	9.0 × 14.0	2.7	-	54	-	-	-	
Seminar room A,B,C	2	189	9.0 × 21.0	2.7	-	126	-	-	-	
Hotto room	2	63	9.0 × 7.0	2.7	-	30	-	-	-	

Width × Depth and the floor area may not match depending on the shape of the room.

Komatsu Chamber of Commerce and Industry

Small and Medium Enterprises Seminar House

Ni-1 Sono-machi, Komatsu 923-8566
 TEL: 0761-21-3121 FAX: 0761-21-3120
 URL: <https://komatsu-cci.or.jp/>



3FLarge hall(Large conference room)



■ Number of seats
200 seats (3F large hall in school style)
440 seats (3F large hall in theater style)



■ Traffic access
 10 min by bus from JR Komatsu Station (Get off at Komatsu Shokokaigisho-mae and walk for 1 min.)
 5 min by taxi from JR Komatsu Station



■ Hours
 9:00am~9:00pm (Weekday)
 9:00am~5:00pm (Sat, Sun, holiday)
 Closed: Year-end and New Year's holidays (Dec. 29~Jan. 3)

■ Date to start accepting reservation
 At any time



■ Accommodation
 None



■ Restaurants/Cafés
 None



■ Parking
80 vehicles (free)



■ Remarks
 None

Floor plan

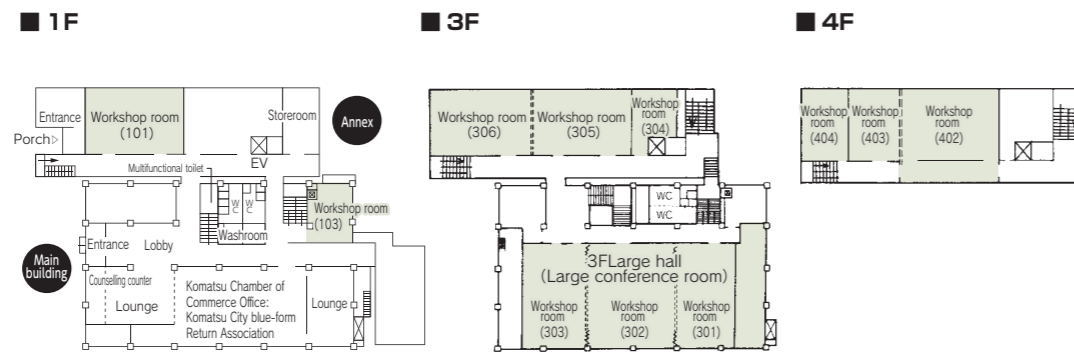

■ Convention site

Site name	Floor	Area(m ²)	Width × Depth (m)	Ceiling height(m)	Capacity (persons)					Remarks
					Fixed seats	School	Theater	Seated	Buffet	
101	1	81	10.7 × 7.6	3.0	-	42	56	-	-	
103	1	39	7.5 × 5.4	2.5	-	16	20	-	-	
3FLarge hall(Large conference room)	3	339	26.0 × 13.0	4.0	-	200	440	-	-	With a stage, the space can be partitioned into three rooms.
304 (Japanese-style room)	3	12.5-tatami-mat	6.0 × 5.3	2.5	-	8	-	-	-	
305, 306	3	162	23.1 × 7.0	3.0	-	102	200	-	-	The space can be partitioned into two rooms.
402	4	81	10.8 × 7.5	3.0	-	42	40	-	-	
403	4	40	7.0 × 5.8	3.0	-	16	20	-	-	
404	4	40	7.0 × 5.8	3.0	-	16	20	-	-	

Width × Depth and the floor area may not match depending on the shape of the room.

Komatsu Dome

Ho-5 Hayashi-machi, Komatsu 923-0344
 TEL: 0761-43-1677 FAX: 0761-43-4466
 URL: <http://kskousya.com>



■ Number of seats
5,000 seats (Arena)
312 seats (Assembly hall)



■ Traffic access
 15-min drive from JR Komatsu Station
 5-min drive from JR Awazu Station
 15-min drive from JR Kaga Onsen Station
 20-min drive from Komatsu Airport
 20-min drive from Komatsu IC or Kaga IC of Hokuriku Expressway



■ Hours
 9:00am~10:00pm
 Closed: Year-end and New Year's holidays (Dec. 29~Jan. 3)

■ Date to start accepting reservation
 · Arena, Conference room, Meeting room 1~4, Lifelong learning room, Japanese-style room: Beginning of the month three months before the date of use
 * Arena: Six months or one year before the date of use depending on the usage
 · Assembly hall: Beginning of the month six months before the date of use



■ Accommodation
 None



■ Restaurants/Cafés
 None



■ Parking
804 vehicles



■ Remarks
 None

Floor plan

■ 1F

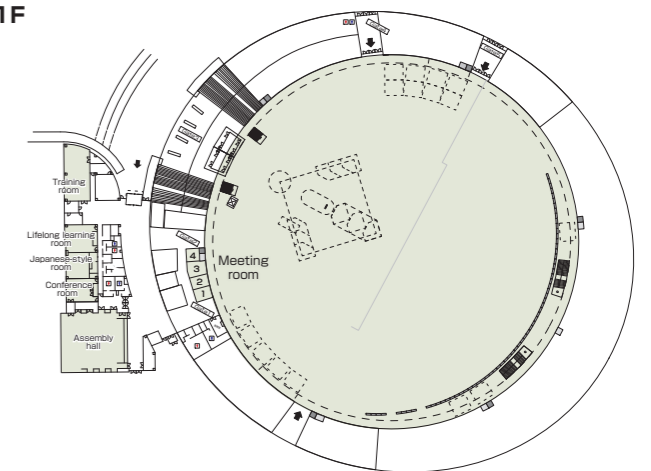

■ Convention site

Site name	Floor	Area(m ²)	Width × Depth (m)	Ceiling height(m)	Capacity (persons)					Remarks
					Fixed seats	School	Theater	Seated	Buffet	
Arena	1	14,344		56		5,000				
Assembly hall	1	444			312	240	400	156		
Conference room	1	80			45	36				
Meeting room 1~4	1	103								
Meeting room 1	1	28			12					
Meeting room 2	1	26			12					
Meeting room 3	1	27			12					
Meeting room 4	1	22			12					
Lifelong learning room (Cooking classroom)	1	106			36					
Training room	1	170								
Japanese-style room	1	97				10				

Width × Depth and the floor area may not match depending on the shape of the room.

Komatsu Hokuden Hall (temporary name)

1-100 Hinode-machi, Komatsu 923-0868
TEL: 0761-24-3036

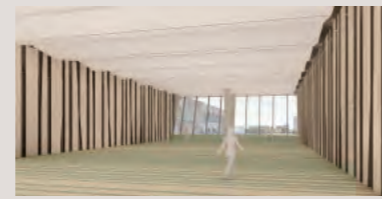
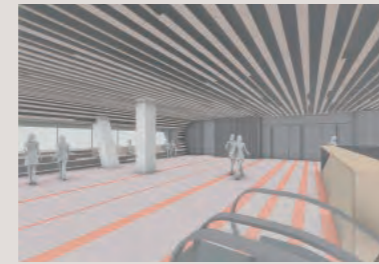
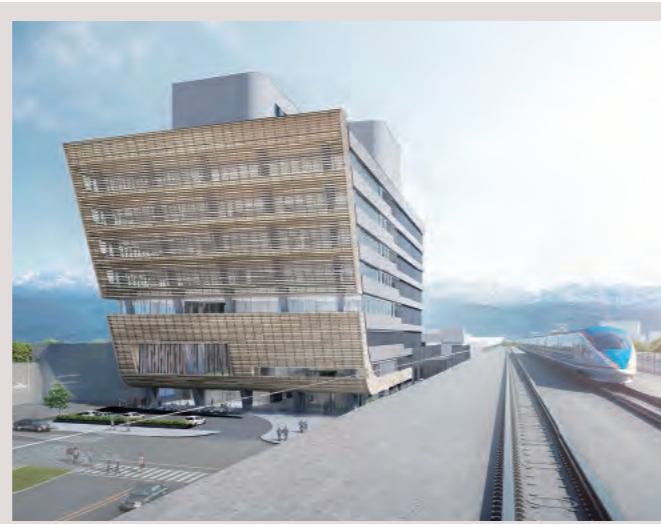

Floor plan



■ Number of seats
620 seats (Hall 1+2+3+Waiting room in seated style)
780 seats (Hall 1+2+3 in theater style)



■ Traffic access
1-min walk from JR Komatsu Station
12 min by bus from Komatsu Airport
10-min drive from Komatsu IC of Hokuriku Expressway



■ Hours
9:00am~10:00pm
Open year-round



■ Accommodation
On 9F and 10F,
GRANBINARIO KOMATSU Annex (temporary name):
66 single rooms



■ Restaurants/Cafés
To be installed in the hall



■ Parking
None
* Please use pay parking around JR Komatsu Station



■ Remarks
None

■ Convention site

Site name	Floor	Area(m ²)	Width × Depth (m)	Ceiling height(m)	Capacity (persons)					Remarks
					Fixed seats	School	Theater	Seated	Buffet	
Hall 1	2	220	Approx. 13.0 × 15.0	5.5	—	100	260	190	260	
Hall 2	2	185	Approx. 11.0 × 15.0	5.5	—	80	220	160	220	
Hall 3	2	250	Approx. 15.0 × 15.0	5.5	—	110	300	210	300	
Hall 1+2	2	405	Approx. 24.0 × 15.0	5.5	—	180	480	350	480	
Hall 2+3	2	435	Approx. 26.0 × 15.0	5.5	—	190	520	370	520	
Hall 1+2+3	2	655	Approx. 40.0 × 15.0	5.5	—	290	780	560	780	
Hall 1+2+3+Waiting room	2	730	Approx. 45.0 × 15.0	5.5	—	—	—	620	870	

Width × Depth and the floor area may not match depending on the shape of the room.

Science Hills Komatsu (Creative Science Museum)

2 Komatsunomori, Komatsu 923-8610
TEL: 0761-22-8610 FAX: 0761-23-8686
URL: <http://science-hills-komatsu.jp>
E-mail: kagaku@city.komatsu.lg.jp



Wakuwaku hall A,B,C

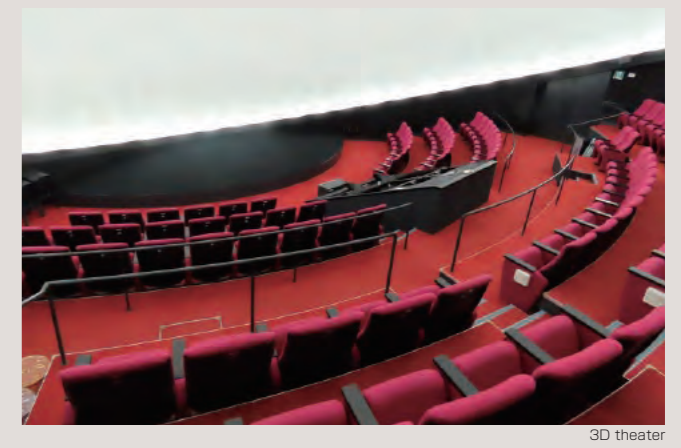

3D theater

Floor plan

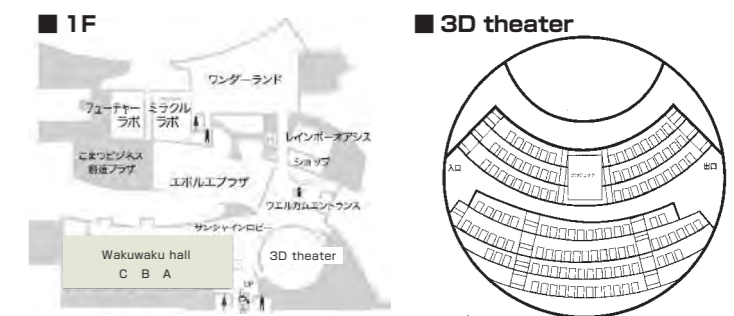

■ Number of seats
120 seats (3D theater)
180 seats (When Wakuwaku Hall A, B and C are used together)
* Wakuwaku hall is provided with movable partitions.



■ Traffic access
8-min drive from Komatsu IC of Hokuriku Expressway
10-min drive from Komatsu Airport
3-min walk from JR Komatsu Station East Exit



■ Hours
9:30am~10:00pm
Closed: Monday (the following weekday when Monday is a holiday), (Open during Golden Week and summer vacation), year-end and New Year's holidays (Dec. 29~Jan. 3)
In addition, the facility may be closed temporarily due to maintenance.

■ Date to start accepting reservation
Beginning of the month one year before the date of use



■ Accommodation
None



■ Restaurants/Cafés
Café restaurant: 35 seats



■ Parking
[Municipal] Hill's parking (pay):
89 vehicles (incl. two wheelchair spaces)
Parking fee: 100yen for the first hour, additional fee: 50yen for every 30min



■ Remarks
None

■ Convention site

Site name	Floor	Area(m ²)	Width × Depth (m)	Ceiling height(m)	Capacity (persons)					Remarks
					Fixed seats	School	Theater	Seated	Buffet	
Wakuwaku hall A	1	247.5	16.1 × 13.8	5	—	126	180	80	180	
Wakuwaku hall B	1	247.5	16.1 × 13.8	5	—	126	180	80	180	
Wakuwaku hall C	1	247.5	16.1 × 13.8	5	—	126	180	80	180	
Wakuwaku hall A,B,C	1	742.5	48.3 × 13.8	5	—	300	300	200	500	
3D theater	1	200	16.0(Diameter)	10.35	120	—	—	—	—	

Width × Depth and the floor area may not match depending on the shape of the room.

Manten-no Tsujinoya

i-18 Yunokami-machi, Komatsu 923-0332
 TEL: 0761-65-1311 FAX: 0761-65-1313
 URL: <https://www.mantenno.com/>
 E-mail: info-tsujinoya@hhh-japan.com



Floor plan

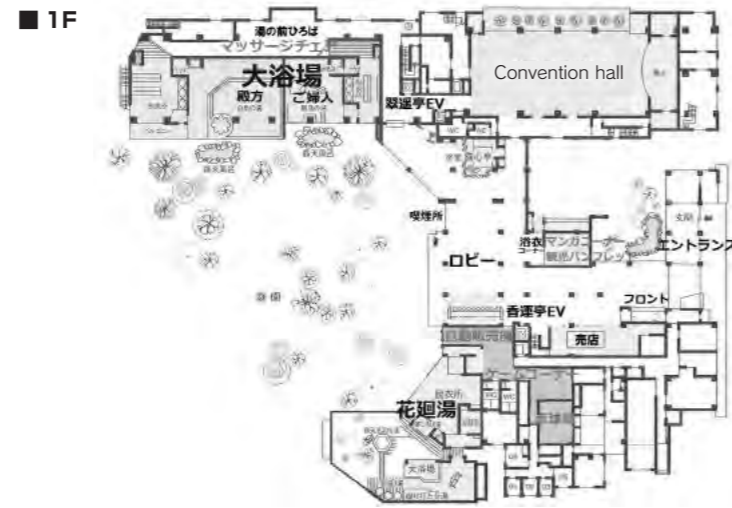

- Number of seats
120 seats (Convention hall in school style)
- Traffic access
10-min drive from JR Awazu Station
- Hours
9:00am~10:00pm
- Date to start accepting reservation
- Accommodation
 ・ "Kountei": 27 rooms
 ・ "Suiyotei": 35 rooms
 Total : 62 rooms
- Restaurants/Cafés
None
- Parking
90 vehicles (free)
- Remarks
Wi-fi accessible

■ Convention site

Site name	Floor	Area(m ²)	Width x Depth (m)	Ceiling height(m)	Capacity (persons)					Remarks
					Fixed seats	School	Theater	Seated	Buffet	
Convention hall	1	350	13 x 27	2.5	—	120	150	—	—	

Width x Depth and the floor area may not match depending on the shape of the room.

Route-Inn Grantia Komatsu Airport

4-116-1 Nagasaki-machi, Komatsu 923-0004
 TEL: 050-5847-7505 (IP phone)
 FAX: 0761-23-7010
 URL: <https://www.route-inn.co.jp/>
 E-mail:
g-komatsu@route-inn.co.jp (Accommodation/ Inquiries)
g-komatsu-banquet@route-inn.co.jp (Banquet)



- Number of seats
400 seats (Kyoka)
- Traffic access
5-min drive from Komatsu Airport
7-min drive from JR Komatsu Station
1-min drive from Komatsu IC
- Hours
9:00am~10:00pm (Meeting room and banquet room)
- Date to start accepting reservation
One year before the date of use
- Accommodation
 ・ Main building : 41
 ・ Annex (Biz court): 156
 Total : 197 rooms
- Restaurants/Cafés
Main building 1F
Restaurant "Nagomi" (Open 6:00pm~10:00pm) (LO: 9:30pm)
* Closed: Sunday and Monday
- Parking
270 vehicles
- Remarks
 ・ Natural hot spring "Ataka-no-yu" on the main bldg. 3F.
 ・ Golf driving range: 6:00am~10:00pm
 ・ Tennis court: 7:00am~5:00pm
 ・ Pickup buses are available for group tours. (Two buses: 28-seat and 25-seat)* Please consult us.

Cancellation policy
 ◆ On the day: 100%
 ◆ 15 days before: 50%
 ◆ 31 days before: 10%

Floor plan

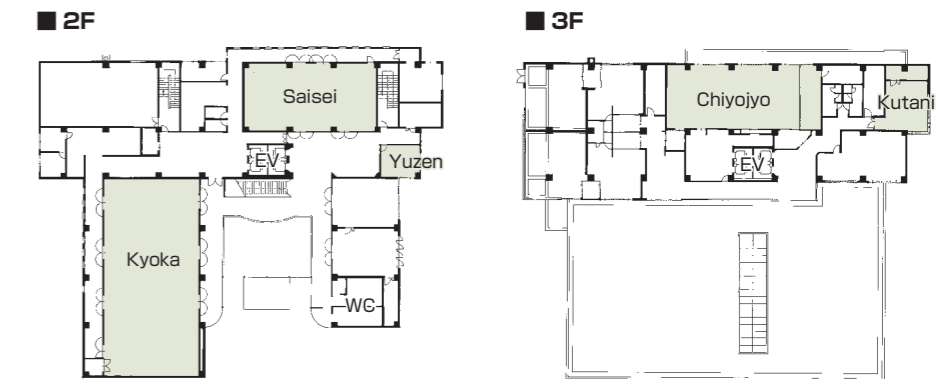

■ Convention site

Site name	Floor	Area(m ²)	Width x Depth (m)	Ceiling height(m)	Capacity (persons)					Remarks
					Fixed seats	School	Theater	Seated	Buffet	
Kyoka (entire room)	2 (Main building)	333					400	175	400	
Kyoka (half)	2 (Main building)	166					200	63	100	
Saisei (entire room)	2 (Main building)	160					200	56	100	
Saisei (half)	2 (Main building)	80					90	28	50	
Chiyojo (entire room)	3(Main building)	90-tatami-mat								
Chiyojo (half)	3(Main building)	45-tatami-mat								
Kutani	3 (Main building)	40						7		
Yuzen	2 (Main building)	24								

Width x Depth and the floor area may not match depending on the shape of the room.

Municipal Lyceum in Kaga "Come On a Hall"

2-68 Hokubu, Yamashiro Onsen, Kaga 922-0243
 TEL: 0761-77-2811 FAX: 0761-77-5681
 URL: <http://kaga-bunka.lolipop.jp>



■ Number of seats
1,426 seats (Hall)
 (Six wheelchair spaces, 1,310 seats are available when the orchestra pit is used)



■ Traffic access
 15-min drive from Kaga IC of Hokuriku Expressway
 15-min drive from Katayamazu IC of Hokuriku Expressway
 7 min by bus from JR Kaga Onsen Station
 (Get off at Bunka-kaikan-mae and walk for 2 min.)
 25 min by taxi from Komatsu Airport



■ Hours
 9:00am~10:00pm
 Closed: Year-end and New Year's holidays (Dec. 29~Jan. 3), maintenance and inspection period

■ Date to start accepting reservation
 Hall and meeting room: One year before the date of use
 Meeting room only: Six months before the date of use



■ Accommodation
 None



■ Restaurants/Cafés
 • Tea ceremony room
 • Coffee shop



■ Parking
300 vehicles (free)



■ Remarks
 None

Floor plan

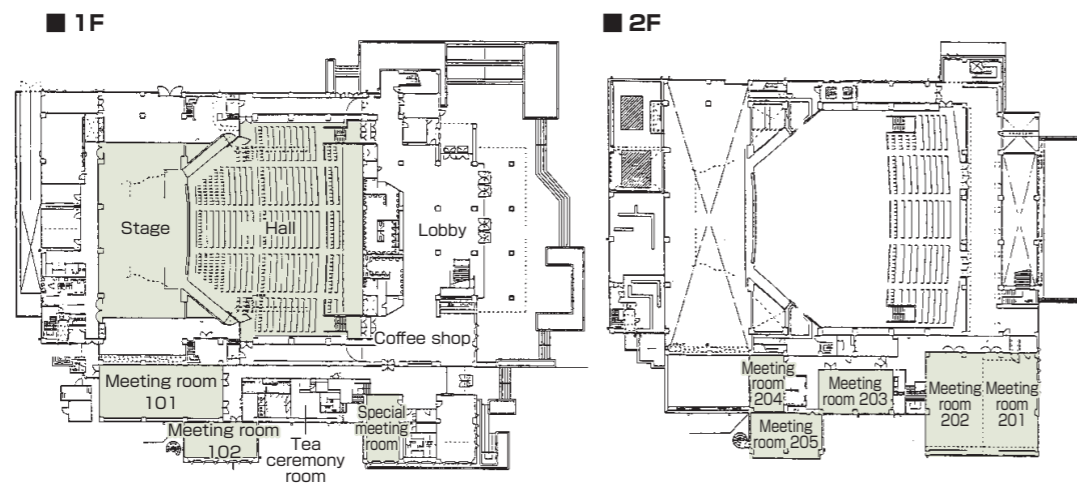

■ Convention site

Site name	Floor	Area(m ²)	Width × Depth (m)	Ceiling height(m)	Capacity (persons)					Remarks
					Fixed seats	School	Theater	Seated	Buffet	
Hall	1	964	33.7 × 40.9	-	1,426	-	-	-	-	With an orchestra pit
Meeting room 101	1	162	18.5 × 8.5	2.7 ~ 3.2	-	108	144	-	-	} Combined use is possible.
Meeting room 102	1	72	11.2 × 6.0	2.5 ~ 3.0	-	36	60	-	-	
Special meeting room	1	62	5.6 × 10.2	2.5	14	-	-	-	-	
Meeting room 201	2	131	8.4 × 14.5	2.9	-	90	150	-	-	
Meeting room 202	2	131	8.4 × 14.5	2.9	-	90	150	-	-	
Meeting room 203	2	77	10.9 × 6.2	2.7 ~ 3.2	-	42	63	-	-	
Meeting room 204	2	48	5.4 × 8.5	2.5	-	24	-	-	-	
Meeting room 205	2	75	10.9 × 6.2	2.5	-	36	70	-	-	

Width × Depth and the floor area may not match depending on the shape of the room.

Katayamazu Onsen Kasuikyo

i-72-1 Ushiozu-machi, Kaga 922-0411
 TEL: 0761-74-1200 FAX: 0761-74-4531
 URL: www.kasuikyo.com
 E-mail: kasuikyo@apa.co.jp

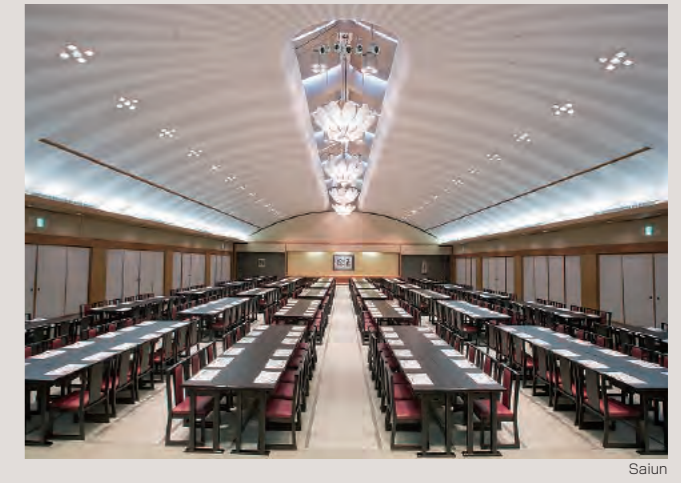

■ Number of seats
250 ~ 500 seats (Convention hall "Saiun")



■ Traffic access
 10 min by taxi from JR Kaga Onsen Station
 20 min by taxi from Komatsu Airport



■ Hours
 9:00am~10:00pm
 Open year-round

■ Date to start accepting reservation
 Beginning of the month one year before the date of use



■ Accommodation
 Available



■ Restaurants/Cafés
 Japanese Restaurant "Kaga": 174 seats



■ Parking
200 vehicles (free)



■ Remarks
 Small and medium-sized meeting rooms are available.

Floor plan

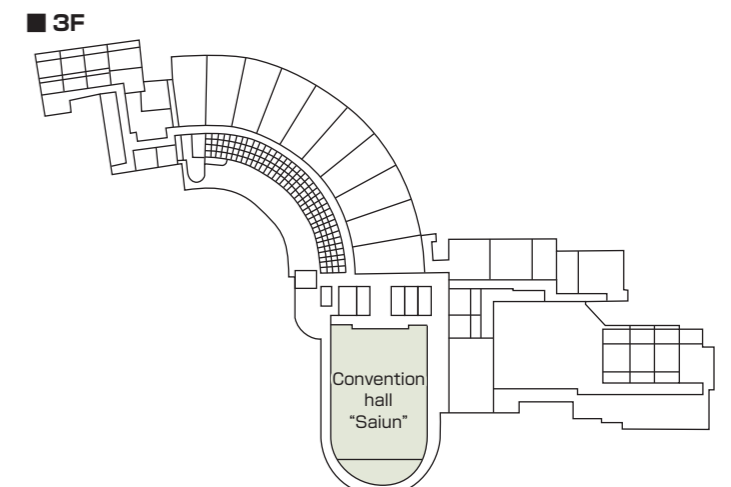

■ Convention site

Site name	Floor	Area(m ²)	Width × Depth (m)	Ceiling height(m)	Capacity (persons)					Remarks
					Fixed seats	School	Theater	Seated	Buffet	
Saiun	3	350-tatami-mat	27.0 × 20.7	5.0	-	250	500	400	400	

Width × Depth and the floor area may not match depending on the shape of the room.

Hatori

17 Yamashiro Onsen-dori, Kaga 922-0254
 TEL: 0761-77-8200 FAX: 0761-77-1900
 URL: <http://hatori.jp/>



Hoshi



Number of seats
100 seats (Hoshi)



Traffic access
 15-min drive from Kaga IC of Hokuriku Expressway
 Pickup bus from JR Kaga Onsen Station from 1:30pm to 6:00pm (Reservation required)
 10 min by taxi from JR Kaga Onsen Station
 25 min by taxi from Komatsu Airport



Hours
 8:00am~10:00pm

Date to start accepting reservation
 One year before the date of use



Accommodation
 • Suite room (with an open-air bath): 6 rooms
 • Deluxe room: 26 rooms
 • Standard room: 27 rooms
 • Single room: 8 rooms
 Total: 67 rooms (250 people)



Restaurants/Cafés
 • Restaurant "Uzuki": 52 seats
 • Dining "Uzuki": 69 seats



Parking
 • 60 vehicles
 • 30 buses



Remarks
 Wireless LAN accessible
 All rooms are no-smoking (there is a dedicated smoking area inside the hotel)

Floor plan

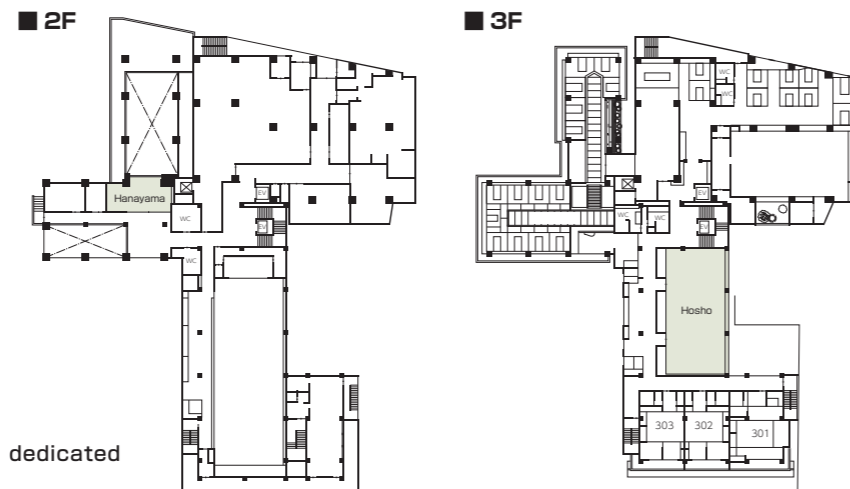

Convention site

Site name	Floor	Area(m ²)	Width × Depth (m)	Ceiling height(m)	Capacity (persons)					Remarks
					Fixed seats	School	Theater	Seated	Buffet	
Hoshi	3	120	7.7 × 15.6	2.4	—	70	100	—	—	
Hanayama	2	28	4 × 7	2.4	12	—	—	—	—	

Width × Depth and the floor area may not match depending on the shape of the room.

Hotel Arrowle

To-5-1 Shibayama-machi, Kaga 922-0402
 TEL: 0761-75-8000 FAX: 0761-75-8008
 URL: <http://www.arrowle.co.jp>
 E-mail: info@arrowle.co.jp



Zuisyo



Number of seats
630 seats (Zuisyo)



Traffic access
 5-min drive from Katayamazu IC of Hokuriku Expressway
 15 min by taxi from JR Kaga Onsen Station
 15 min by taxi from Komatsu Airport
 Pickup service is available by reservation.



Hours
 8:00am~10:00pm
 Open year-round

Date to start accepting reservation
 At any time



Accommodation
 • Standard twin room: 48
 • Hollywood twin room: 6
 • Standard double room: 6
 • Deluxe twin room: 38
 • Luxury twin room: 11
 • Deluxe triple room: 20
 • Royal suite: 1
 Total: 130 rooms (300 people)



Restaurants/Cafés
 • Terrace Restaurant "Bellavista": 83 seats
 • Japanese Cuisine "Chikusui"
 Table: 66 seats
 Counter: 10 seats
 Japanese style: 3 rooms



Parking
 285 vehicles (free)



Remarks
 Wireless LAN accessible

Floor plan

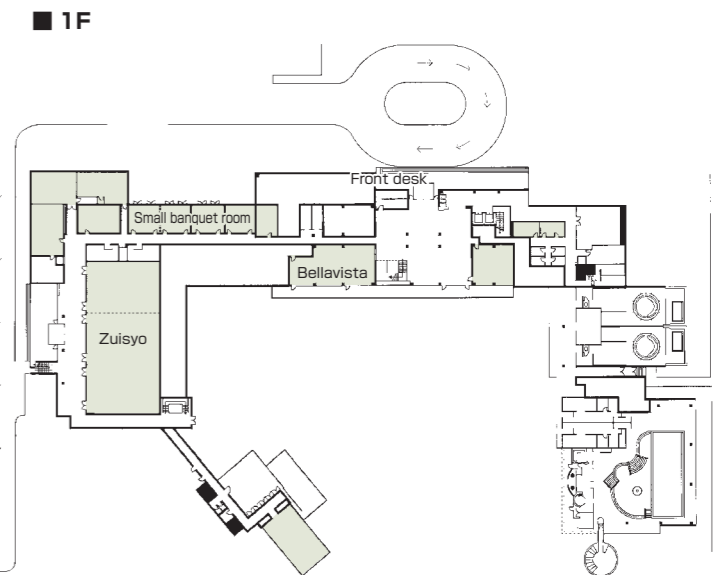

Convention site

Site name	Floor	Area(m ²)	Width × Depth (m)	Ceiling height(m)	Capacity (persons)					Remarks
					Fixed seats	School	Theater	Seated	Buffet	
Zuisyo (entire)	1	646	16.6 × 37.4	6.0	—	420	630	300	540	
Zuisyo (2/3)	1	428	16.6 × 23.9	6.0	—	250	370	200	360	
Zuisyo (1/3)	1	213	16.6 × 12.9	6.0	—	80	140	100	180	
Medium-sized banquet room	1	112	6.3 × 14.5	3.0	—	50	70	40	90	A room created by connecting two small banquet rooms.
Small banquet room	1	56	6.3 × 7.3	3.0	—	25	40	15	45	4 rooms

Width × Depth and the floor area may not match depending on the shape of the room.

Kaga Hyakumangoku

11-2-1 Yamashiro Onsen, Kaga, 922-0242
 TEL: 0761-77-0200 FAX: 0761-77-0201
 URL: <https://www.kaga-hyakumangoku.jp/>
 E-mail: yoyaku@kaga-hyakumangoku.jp



Convention hall "Sakura"

Floor plan

■ 2F

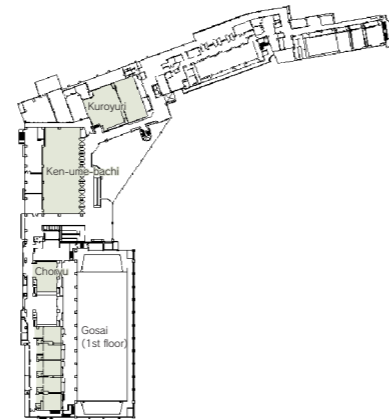

■ Number of seats
900 seats (Convention hall "Gosai" in theater style)



■ Traffic access
 10-min drive from JR Kaga Onsen Station
 Free pickup bus is available (reservation required)



■ Hours
 9:00am~10:00pm

■ Date to start accepting reservation
 One year before the date of use



■ Accommodation
 • Main building: 179 rooms (813 people)
 • Annex: 45 rooms (210 people)



■ Restaurants/Cafés
 • Restaurant "Umeno-an"
 • Shop
 • Karaoke room



■ Parking
 • 200 vehicles
 • 20 large buses



■ Remarks
 27 large and small banquet rooms
 Wi-Fi accessible

■ Convention site

Site name	Floor	Area(m ²)	Width × Depth (m)	Ceiling height(m)	Capacity (persons)					Remarks
					Fixed seats	School	Theater	Seated	Buffet	
Convention hall "Ken-ume-bachi"	2	560	16.5 × 36.5	3.4		500	800	250		The space can be partitioned into two rooms.
Convention hall "Sakura"	2	460	20.0 × 20.0	4.0		500	800	230		The space can be partitioned into two rooms.
Kikuzakura	1	240	9.0 × 26.0	3.5		120	180	80		The space can be partitioned into two rooms.
Gosai	1	1,000	21.6 × 41.5	5.0		700	900	600		The space can be partitioned into two rooms.
Kuroyuri	2	175	9.5 × 18.0	2.7		100	150	65		
Choryu	2	96	8.1 × 12.0	2.8		55	90	40		

Width × Depth and the floor area may not match depending on the shape of the room.

Yamanaka Onsen Cultural Center

To-5-1 Nishikatsuragi-machi, Yamanaka Onsen, Kaga
 922-0112
 TEL: 0761-78-3311 FAX: 0761-78-3435



Large hall

Floor plan

■ 2F

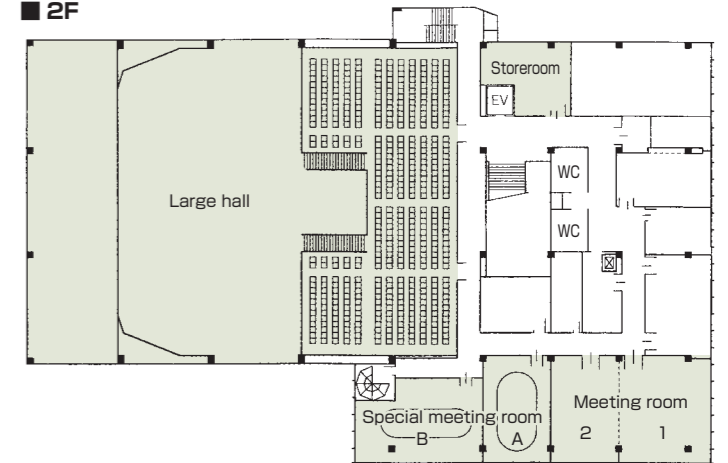

■ Number of seats
1,158 seats
 (Large hall: One-floor type (Fixed seats: 458, Movable seats: 700))



■ Traffic access
 20min by bus from JR Kaga Onsen Station
 (Get off at Yamanaka Onsen and walk for 2 min.)
 30-min drive from Komatsu Airport
 20-min drive from Kaga IC of Hokuriku Expressway



■ Hours
 9:00am~10:00pm
 Closed: Year-end and New Year's holidays (Dec. 29~Jan. 3)

■ Date to start accepting reservation
 Six months before the date of use



■ Accommodation
 None



■ Restaurants/Cafés
 None



■ Parking
 30 vehicles (free)



■ Remarks
 The Hotel Association, Tourism Association and Commerce and Industry Association are co-located within the building.
 We can assist with a range of services, according to your needs, such as layout planning, site management, pickup bus arrangement (between JR Kaga Onsen Station/Komatsu Airport, conference venue, and hotels), and the preparation and cleaning of venues.
 (Yamanaka Onsen Hotel Association: TEL: 0761-78-0330)

■ Convention site

Site name	Floor	Area(m ²)	Width × Depth (m)	Ceiling height(m)	Capacity (persons)					Remarks
					Fixed seats	School	Theater	Seated	Buffet	
Large hall	1・2	375.0	15.0 × 25.0	—	458	—	1158	—	—	1F: Movable seats: 700, 2F: Fixed seats: 458
Meeting room 1	2	79.9	8.9 × 9.0	2.6	—	50	—	—	—	
Meeting room 2	2	53.4	6.0 × 9.0	2.6	—	30	—	—	—	
Special meeting room A	2	53.2	6.0 × 9.2	2.6	20	—	—	—	—	Round table
Special meeting room B	2	74.0	10.8 × 7.1	2.6	26	—	—	—	—	Round table

Width × Depth and the floor area may not match depending on the shape of the room.

Yamanaka-za

Mu-1 Yakushi-machi, Yamanaka Onsen, Kaga
922-0123
TEL: 0761-78-5523 FAX: 0761-78-5524
URL: <http://www.yamanaka-spa.or.jp/yamanakaza/>



Yamanakaza Hall

Floor plan

■ 1F

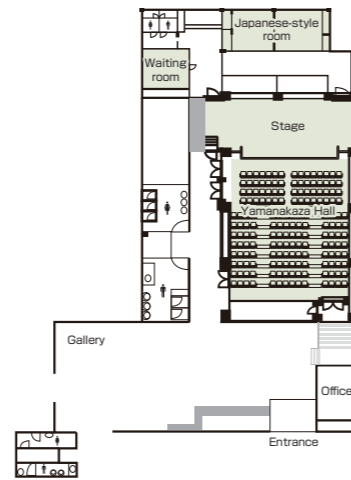

■ Number of seats
180 seats



■ Traffic access
15-min drive from JR Kaga Onsen Station
30 min by bus from JR Kaga Onsen Station
40-min drive from Komatsu Airport



■ Hours
8:30am~10:00pm
(*The facility cannot be used from 2:30pm to 4:30pm due to regular performance on Sat, Sun and holidays.) Open year-round

■ Date to start accepting reservation
Six months before the date of use (Temporary reservation is accepted separately.)



■ Accommodation
None



■ Restaurants/Cafés
None



■ Parking
30 vehicles



■ Remarks
None

■ Convention site

Site name	Floor	Area(m ²)	Width × Depth (m)	Ceiling height(m)	Capacity (persons)					Remarks
					Fixed seats	School	Theater	Seated	Buffet	
Yamanakaza Hall	1	165			172	90				Fixed seats: 112, Movable seats: 60, Extra seats: 30
Japanese-style room	1	Two 10-tatami-mat rooms								
Waiting room	1	6-tatami-mat								
Lobby	1	117								
Gallery	1	28								
Yamanakaza Square	1	490								

Width × Depth and the floor area may not match depending on the shape of the room.

Yunokuni Tensyo

19-49-1 Yamashiro Onsen, Kaga 922-0298
TEL: 0761-77-1234 FAX: 0761-77-1260
URL: <http://tensyo.yunokuni.jp/>
E-mail: tensyo@yunokuni.jp



Convention hall "Tensyo"

Floor plan

■ 1F

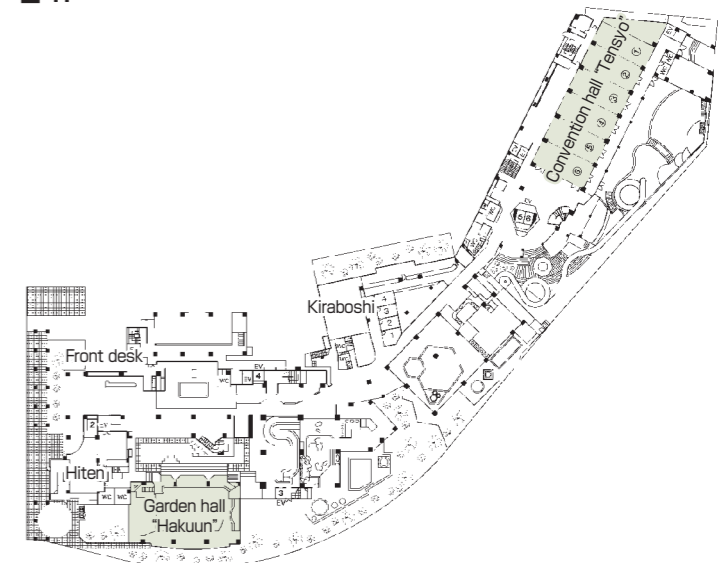

■ Number of seats
560 seats (convention hall "Tensyo" in theater style)
400 seats (convention hall "Tensyo" in school style)



■ Traffic access
10 min by taxi from JR Kaga Onsen Station
*Pickup bus is available from 2:20pm to 6:20pm.
25 min by taxi from Komatsu Airport



■ Hours
8:00am~6:00pm

■ Date to start accepting reservation
One year before the date of use



■ Accommodation
• Tensyo: 48 rooms
• Hakuun: 88 rooms
• Western-style room: 20
Total: 156 rooms, 700 people



■ Restaurants/Cafés
• Coffee lounge: 80 seats
• Shop, etc.



■ Parking
300 vehicles (free)



■ Remarks
19 meeting rooms are available.

■ Convention site

Site name	Floor	Area(m ²)	Width × Depth (m)	Ceiling height(m)	Capacity (persons)					Remarks
					Fixed seats	School	Theater	Seated	Buffet	
Convention hall "Tensyo"	1	422	36.7 × 11.3	4.0	—	400	560	250	—	The space can be partitioned into six rooms.
Garden hall "Hakuun"	1	217	17.5 × 17.4	3.0	—	180	—	—	—	
Kiraboshi	1	112	12.3 × 9.1	2.9	—	70	—	—	—	
Hiten	1	57	6.0 × 9.6	2.5	—	20	—	—	—	
Tenkei (Japanese-style)	2	284-tatami-mat	38.6 × 13.0	3.6	—	300	—	—	—	The space can be partitioned into four rooms
Hiryu (Japanese-style)	2	177-tatami-mat	23.3 × 12.6	3.0	—	160	—	—	—	The space can be partitioned into three rooms.
Ho-Oh	2	321	16.8 × 15.6	2.6	—	120	—	—	—	The space can be partitioned into three rooms.

Width × Depth and the floor area may not match depending on the shape of the room.

Rurikoh

19-58-1 Yamashiro Onsen, Kaga 922-0254
 TEL: 0761-77-2323 FAX: 0761-77-3821
 URL: <http://rurikoh.jp/>



Convention Hall "Hanarikyū"

Floor plan

■ 1F

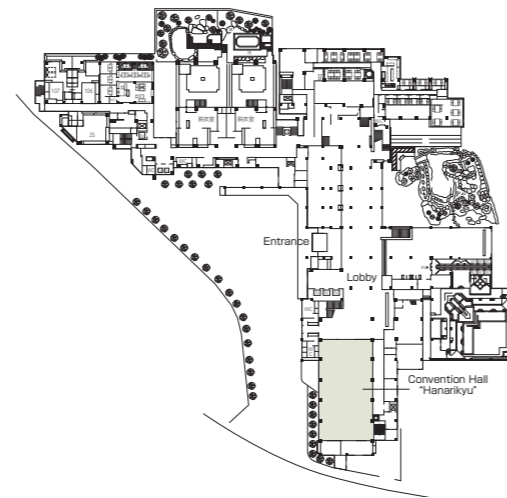

■ Number of seats
250 seats (Hanarikyū)



■ Traffic access
 15-min drive from Kaga IC of Hokuriku Expressway
 Pickup bus from JR Kaga Onsen Station is available.
 *Reservation required (1:30pm ~ 6:00pm)
 10 min by taxi from JR Kaga Onsen Station
 25 min by taxi from Komatsu Airport



■ Hours
 8:00am~10:00pm

■ Date to start accepting reservation
 One year before the date of use



■ Accommodation
 • Suite room (with an open-air bath): 16 rooms
 • Suite room (No open-air bath): 2 rooms
 • Deluxe room: 13 rooms
 • Standard room: 70 rooms
 • Twin room, Single room: 15 rooms
 Total: 116 rooms (500 people)



■ Restaurants/Cafés
 • "Nisaburou": 45 seats
 • Dining "Tenpyou": 68 seats



■ Parking
 • 250 vehicles
 • 30 buses



■ Remarks
 Wireless LAN accessible
 All rooms are no-smoking (there is a dedicated smoking area inside the hotel)

■ Convention site

Site name	Floor	Area(m ²)	Width × Depth (m) (m)	Ceiling height(m)	Capacity (persons)					Remarks
					Fixed seats	School	Theater	Seated	Buffet	
Convention Hall "Hanarikyū"	1	325	13 × 25	3.1	—	200	250	120	—	The space can be partitioned into two rooms.
Heian	2	492			—	200	250	250	—	The space can be partitioned into three rooms.
Ho-oh	2	350			—	100	150	130	—	The space can be partitioned into two rooms.

Width × Depth and the floor area may not match depending on the shape of the room.

Suzu Beach Hotel

1-2-480 Takojima-machi, Suzu 927-1204
 TEL: 0768-82-7000 FAX: 0768-82-7001
 E-mail: info@suzu-beachhotel.jp

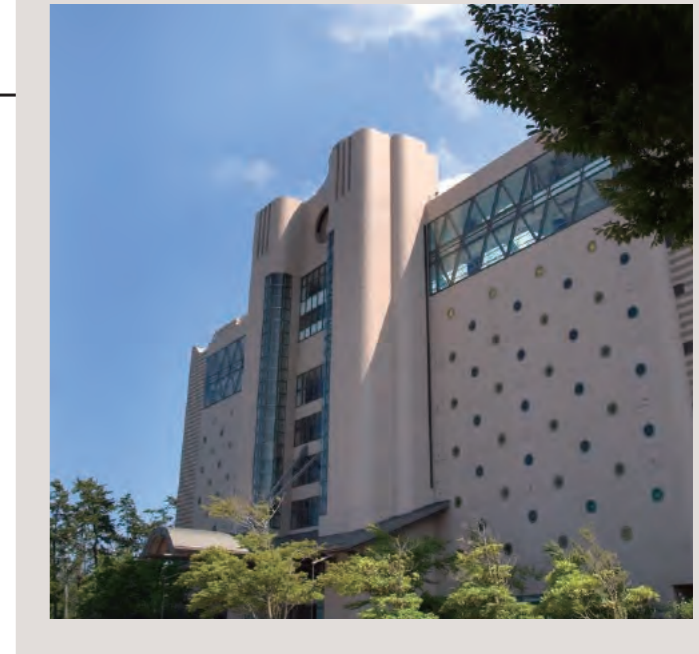

■ Number of seats
80 seats (Shikisai)



■ Traffic access
 50-min drive from Noto Satoyama Airport IC



■ Hours
 8:00am~10:00pm

■ Date to start accepting reservation



■ Accommodation
 • Western-style standard room : 28
 • Western-style deluxe room : 2
 • Suite room : 1
 Total: 31 rooms



■ Restaurants/Cafés
 Restaurant "Camellia": 80 seats



■ Parking
 35 vehicles, 3 buses (free)



■ Remarks
 None

Floor plan

■ 2F

Shikisai (usage example)

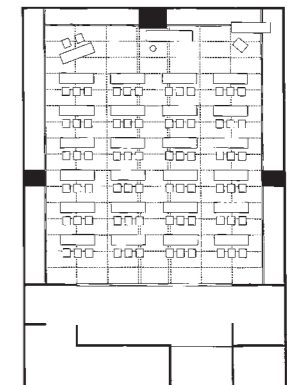

■ Convention site

Site name	Floor	Area(m ²)	Width × Depth (m) (m)	Ceiling height(m)	Capacity (persons)					Remarks
					Fixed seats	School	Theater	Seated	Buffet	
Shikisai	2	155	11.2 × 13.8	2.4	—	70	100	80	120	A carpet is laid on the tatami flooring of the room.

Width × Depth and the floor area may not match depending on the shape of the room.

La Porte Suzu

(Suzu City Multipurpose Hall)

1-1-8 Iida-machi, Suzu 927-1214
 TEL: 0768-82-8200 FAX: 0768-82-7200
 URL: <https://www.city.suzu.lg.jp/site/laporte-suzu/>



Floor plan

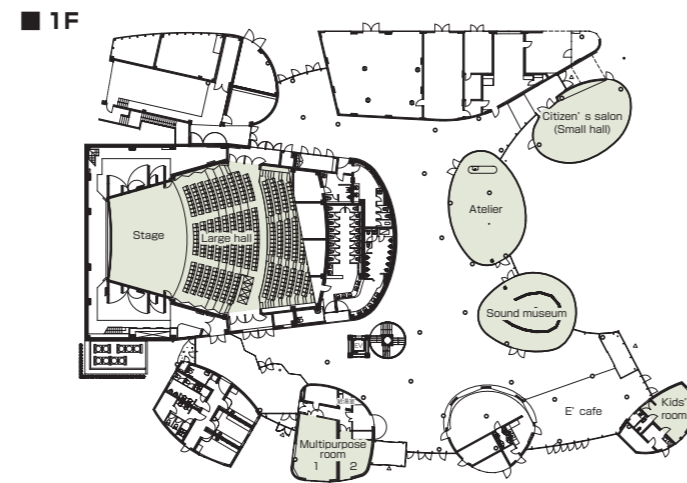

■ Number of seats
538 seats (incl. four wheelchair spaces)



■ Traffic access
 2 hr 30 min from JR Kanazawa Station by Suzu express bus
 (Get off at Suzu Shiyakusho-mae and walk for 5 min)
 2hr 20min drive from Kanazawa via Noto Satoyama Highway
 40 min by Furusato Taxi from Noto Satoyama Airport



■ Hours
 9:00am~10:00pm
 Closed: Tuesday, year-end and New Year's holidays
 (Dec. 29~Jan. 3)

■ Date to start accepting reservation
 Beginning of the month one year before the date of use



■ Accommodation
 None



■ Restaurants/Cafés
 Coffee shop "E' Café": 40 seats



■ Parking
250 vehicles (free)



■ Remarks
 Sound museum "Take-no-fue" (free)

■ Convention site

Site name	Floor	Area(m ²)	Width × Depth (m)	Ceiling height(m)	Capacity (persons)					Remarks
					Fixed seats	School	Theater	Seated	Buffet	
Large hall		794			538					Including four wheelchair spaces
Citizen's salon (Small hall)		90								
Atelier		107								
Sound museum		95								
Multipurpose room 1		44								
Multipurpose room 2		25								
Dressing room1~3		14 people each								
Kids' room		32								
Lobby (incl. a gallery)		1,027								

Width × Depth and the floor area may not match depending on the shape of the room.

Concert Noto

To-29-2 Ushitsu, Noto-cho, Hosu 927-0433
 Ushitsu Community Center
 TEL: 0768-62-3458 FAX: 0768-62-3478
 Central library
 TEL: 0768-62-8520 FAX: 0768-62-8521
 Tourist Information Station "Tabisuta"
 TEL: 0768-62-8530 FAX: 0768-62-8531

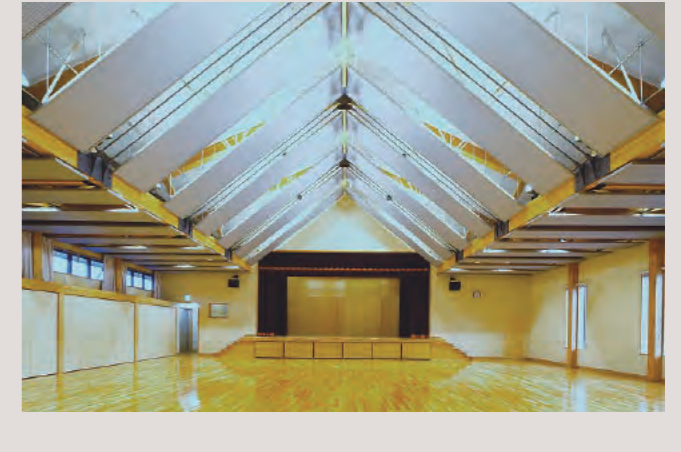

Floor plan



■ Number of seats
312 seats



■ Traffic access
 20 min by taxi from Noto Satoyama Airport
 50 min by bus from Anamizu Station of Noto Railway
 2 hr by express bus from Kanazawa Station
 1-hr 30-min drive from Uchinada IC of Noto Satoyama Highway



■ Hours
 9:00am~10:00pm

■ Date to start accepting reservation
 Five days before the date of use



■ Accommodation
 None



■ Restaurants/Cafés
 Noto Tourist Information Station "Tabisuta"



■ Parking
10 vehicles



■ Remarks
 None

■ Convention site

Site name	Floor	Area(m ²)	Width × Depth (m)	Ceiling height(m)	Capacity (persons)					Remarks
					Fixed seats	School	Theater	Seated	Buffet	
Meeting room 1	2	42.83								
Meeting room 2	2	39.74								
Meeting room 3	2	35.90								
Japanese-style meeting room	2	57.44	*Incl. entrance							
Cooking classroom	2	86.14								
Multipurpose hall	2	240.89								With a stage

Width × Depth and the floor area may not match depending on the shape of the room.

Wajima City Cultural Center

20-1-1 Kawai-machi, Wajima 928-0001
 TEL: 0768-22-7666 FAX: 0768-22-7669
 E-mail: bunka@city.wajima.lg.jp

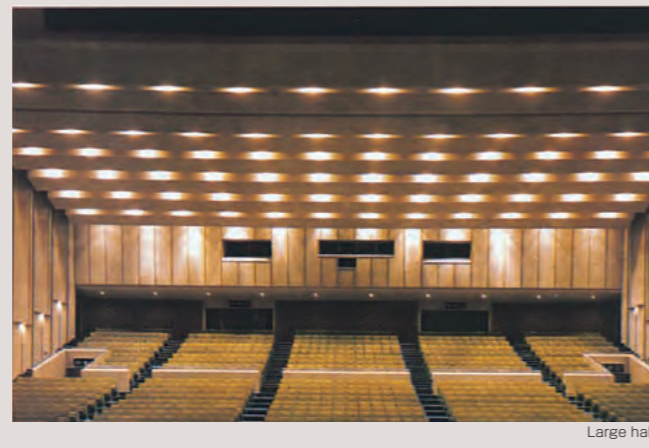

Floor plan

1F

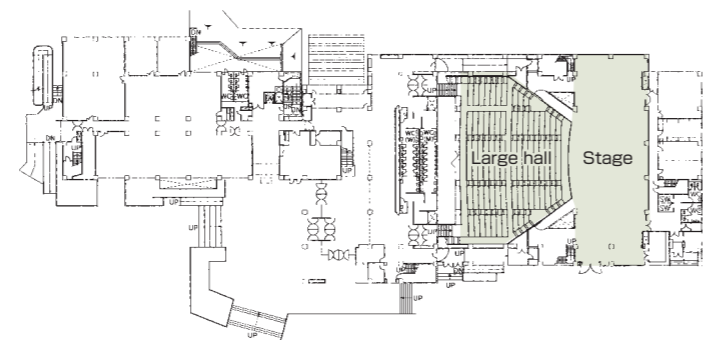

3F



Number of seats
1,200 seats (Large hall)
 *incl. four wheelchair spaces



Traffic access
 130 min by express bus from JR Kanazawa Station
 Kanazawa Port Exit (West Exit) (Get off at Wajima Ekimae.)
 20-min drive from Noto Satoyama Airport IC via
 Noto Satoyama Highway and Noetsu Highway



Hours
 9:00am~10:00pm
 Closed: Mondays (the following weekday when Monday is a holiday), year-end and New Year's holidays (Dec. 29~Jan. 3)

Date to start accepting reservation
 Six months before the date of use



Accommodation
 None



Restaurants/Cafés
 None



Parking
 No.1 parking lot: **97** vehicles (The first hour is free. Event participants can park for additional hours free of charge by completing a procedure.)
 No.2 parking lot: **45** vehicles



Remarks
 Roadside station Wajima Furatto Homu is adjacent to the hall, accessible via a pathway.

Convention site

Site name	Floor	Area(m ²)	Width × Depth (m)	Ceiling height(m)	Capacity (persons)					Remarks
					Fixed seats	School	Theater	Seated	Buffet	
Large hall	-	1,448	18.0 × 14.0	8.0	1,200	-	-	-	-	
Meeting room 301	3	335	9.0 × 4.0	4.0	-	150	300	-	-	Small hall

Width × Depth and the floor area may not match depending on the shape of the room.

Castle Manai

i-61-1 Kawajima, Anamizu-machi, Hosu 927-0027
 TEL: 0768-52-3030 FAX: 0768-52-3031
 URL: <http://castle-manai.jp/>



Castle Hall



Meeting room 1



Meeting room 2

Floor plan

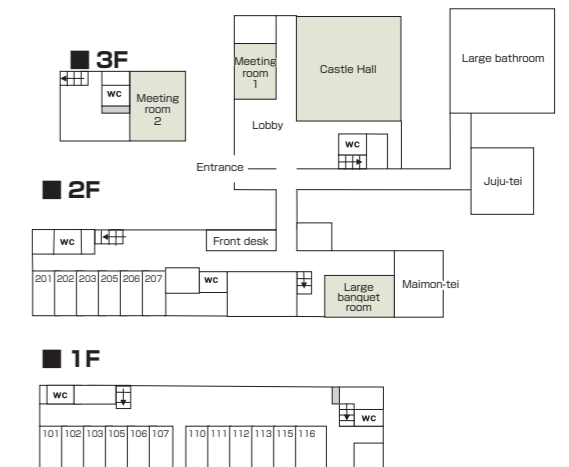

Number of seats
200 seats (Castle Hall)



Traffic access
 30 min by Furusato Taxi from Noto Satoyama Airport (reservation required)
 5 min by taxi from Anamizu Station of Noto Railway
 10-min drive from Anamizu IC of Noto Satoyama Highway



Hours
 8:30am~10:00pm

Date to start accepting reservation



Accommodation
 • Western-style room: 14
 • Japanese-style room: 4
 Total: 18 rooms 62 people



Restaurants/Cafés
 • Restaurant "Maimon-tei": 40 seats
 • Robatayaki restaurant "Juju-tei": 48 seats
 * Lunch box, hors d'oeuvres, Kaiseki course dinner (reservation required)



Parking
60 vehicles (free)



Remarks
 Visitors can take a bath in the large bathroom. (Adult: 520yen)

Convention site

Site name	Floor	Area(m ²)	Width × Depth (m)	Ceiling height(m)	Capacity (persons)					Remarks
					Fixed seats	School	Theater	Seated	Buffet	
Castle Hall	2	306.45	22.7 × 13.5		200	150	150	100	100	
Meeting room 1	2	38	9.5 × 4		20	20	20			
Meeting room 2	3	81	9 × 9		40	40	40			
Large banquet room	2	65-tatami-mat	11.2 × 9			60		40		

Width × Depth and the floor area may not match depending on the shape of the room.

Noto Fureai Cultural Center

5-28-3 Uchiura, Anamizu-machi, Hosu 927-0025
 TEL: 0768-52-3401 FAX: 0768-52-2205
 URL: <http://www1.cnh.ne.jp/anabun/>



Floor plan

1F

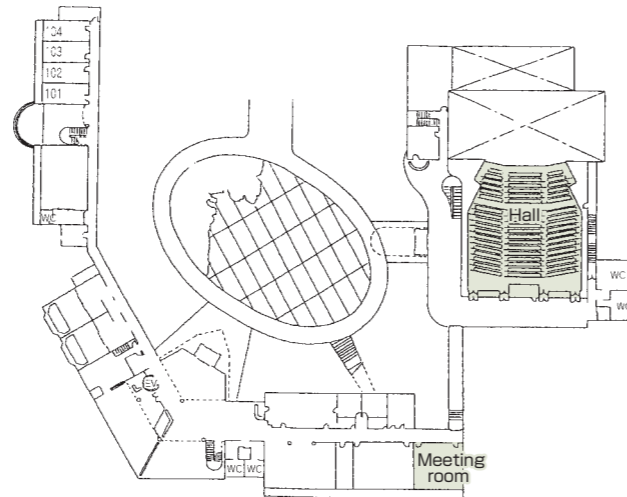

Number of seats
584 seats (Hall)



Traffic access
 5 min by taxi from Anamizu Station of Noto Railway
 10-min drive from Anamizu IC of Noto Satoyama Highway



Hours
 8:30am~10:00pm
 Closed: Year-end and New Year's holidays (Dec. 29~Jan. 3)

Date to start accepting reservation
 One year before the date of use



Accommodation
 • Western-style room : 8 rooms × 3 people
 • Japanese-style room : 3 rooms × 6 people
 • Large banquet room : 1 room × 20 people
 Total : 12 rooms, 62 people



Restaurants/Cafés
 • Dining room: 60 seats
 • Lunch box, hors d'oeuvres, snack (reservation required)



Parking
 200 vehicles (free)



Remarks
 Advance reservation is required for overnight stay.

Convention site

Site name	Floor	Area(m ²)	Width × Depth (m)	Ceiling height(m)	Capacity (persons)					Remarks
					Fixed seats	School	Theater	Seated	Buffet	
Hall	1-2	-	14.0 × 12.0	6.5	584	-	-	-	-	
Meeting room	1	72	9.0 × 8.1	2.7	26	-	-	-	-	
Study room 1	2	72	9.0 × 8.1	2.7	-	36	-	-	-	
Study room 2	2	72	9.0 × 8.1	2.7	-	36	-	-	-	
Study room 3	2	72	9.0 × 8.1	2.7	-	36	-	-	-	
Study room 1+2+3	2	218	27.0 × 8.1	2.7	-	108	-	-	-	

Width × Depth and the floor area may not match depending on the shape of the room.

Aenokaze

8-1 Wakazaki, Wakura-machi, Nanao 926-0192
 TEL: 0767-62-3333 FAX: 0767-62-1123
 URL: <https://www.aenokaze.jp>
 E-mail: reserve@kagaya.co.jp



Number of seats
800 seats (Festival hall "Ho-oh")



Traffic access
 5 min by bus from JR Wakura Onsen Station
 Free pickup bus is available (reservation required)



Hours
 9:00am~10:00pm

Date to start accepting reservation
 One year before the date of use



Accommodation
 Japanese-style room: 126 (670 people)



Restaurants/Cafés
 • "Kirakutei": 80 seats
 • Lounge "Hanaman-yo": 80 seats



Parking
 500 vehicles (free)



Remarks
 None

Floor plan

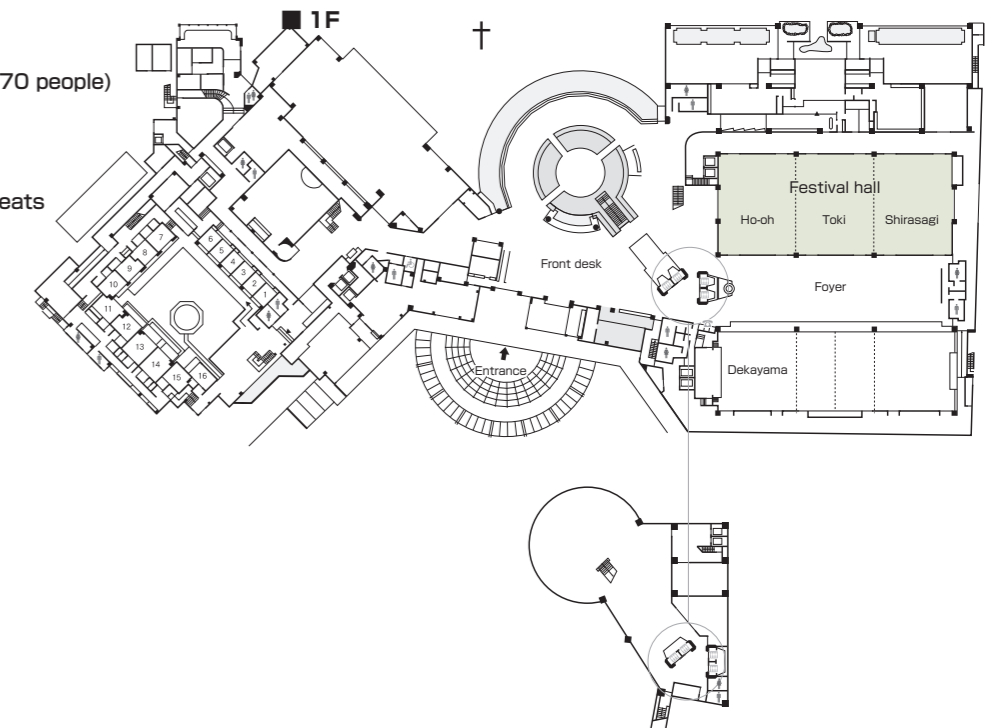

Convention site

Site name	Floor	Area(m ²)	Width × Depth (m)	Ceiling height(m)	Capacity (persons)					Remarks
					Fixed seats	School	Theater	Seated	Buffet	
Festival hall "Ho-oh" (entire room)	1	750	42.0 × 18.0	8.5	-	500	800	300	600	
Ho-oh	1	250	14.0 × 18.0	8.5	-	150	250	80	100	
Toki	1	250	14.0 × 18.0	8.5	-	150	250	80	100	
Shirasagi	1	250	14.0 × 18.0	8.5	-	150	250	80	100	
Festival hall "Ho-oh" + Foyer	1	1,300	42.0 × 31.0	8.5	-	-	1,000	500	1,050	
Festival hall "Ho-oh" + Foyer + Dekayama	1	1,900	42.0 × 46.0	8.5	-	-	-	700	1,500	Dekayama (ceiling height: 2.8m)

Width × Depth and the floor area may not match depending on the shape of the room.

Ishikawa Nanao Art Museum

1-1 Komaruyamada, Nanao 926-0855
 TEL: 0767-53-1500 FAX: 0767-53-6262
 URL: <https://nanao-art-museum.jp>
 E-mail: info@nanao-art-museum.jp



Art Hall



No.3 Exhibition Room (Citizens' Gallery)

Floor plan

■ 2F Art Hall

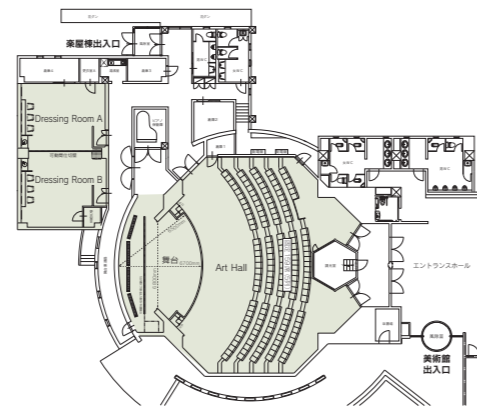

■ 1F No.3 Exhibition Room (Citizens' Gallery)

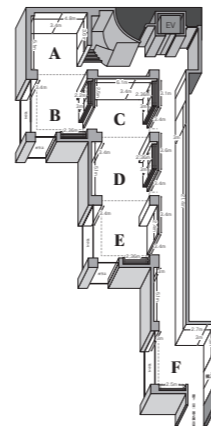

■ Number of seats
240 seats (Art Hall)



■ Traffic access
 By plane: 45 min from Noto Satoyama Airport via Noto Satoyama Highway
 By car: 15 min from Tokuda Otsu JCT of Noto Satoyama Highway, or 10 min from Nanao-joyama IC or Nanao IC of Noetsu Highway
 By taxi: 5 min from JR Nanao Station
 On foot: 20 min-walk from JR Nanao Station
 Loop bus "Marine":
 Take a bus at the "Minakuru" bus stop in front of JR Nanao Station and get off at "Nanao Art Museum" (regular loop: 8min, reverse loop: 14 min, 8 services a day)
 Nanao Community Bus "Gurutto 7": Take a bus from JR Nanao Station Number 5 terminal and get off at "Komaruyama-dai 1 chome" (west route: 10 min, 4 services a day)



■ Hours
 Art Hall: 9:00am~10:00pm
 No.3 Exhibition Room (Citizens' Gallery): 9:00am~5:00pm (admission by 4:30pm)
 Closed: Mondays, days following national holidays, exhibit change periods, year-end and new year holidays
 *There are periods with no closed days



■ Date to start accepting reservation
 Reservations for following year begin from January



■ Accommodation
 None

■ Restaurants/Cafés
 Tea Room



■ Parking
62 vehicles · 4 buses
 (Priority parking: 2 vehicles (next to the back stage))



■ Remarks
 · Entrance equipped with free Wi-Fi
 · Art Hall equipped with Wi-Fi for live streaming

■ Convention site

Site name	Floor	Area(m ²)	Width × Depth (m)	Ceiling height(m)	Capacity (persons)					Remarks
					Fixed seats	School	Theater	Seated	Buffet	
Art Hall	2	315			159	—	—	—	—	Max 240 seats (using movable seating)
Dressing Room A	2	46			—	—	—	—	—	
Dressing Room B	2	45			—	—	—	—	—	
No.3 Exhibition Room (Citizens' Gallery)	1	288		3.4	—	—	—	—	—	Can be divided into five areas. There is a not-available period.

Width × Depth and the floor area may not match depending on the shape of the room.

Kagaya

Yo-bu-80 Wakura-machi, Nanao 926-0192
 TEL: 0767-62-1111 FAX: 0767-62-1121
 URL: <https://www.kagaya.co.jp>
 E-mail: reserve@kagaya.co.jp



Convention hall "Asuka"



■ Number of seats
600 seats
 (Convention hall "Asuka" in theater style)



■ Traffic access
 10 min by bus from JR Wakura Onsen Station
 Free pickup bus is available. (reservation required)



■ Hours
 9:00am~10:00pm

■ Date to start accepting reservation
 One year before the date of use



■ Accommodation
 Japanese-style room: 233 (1,230 people)



■ Restaurants/Cafés
 · Main dining "Shikitei": 120 seats
 · Lounge "Hiten": 100 seats



■ Parking
300 vehicles (free)



■ Remarks
 None

Floor plan

■ Setsugetsuka 4F

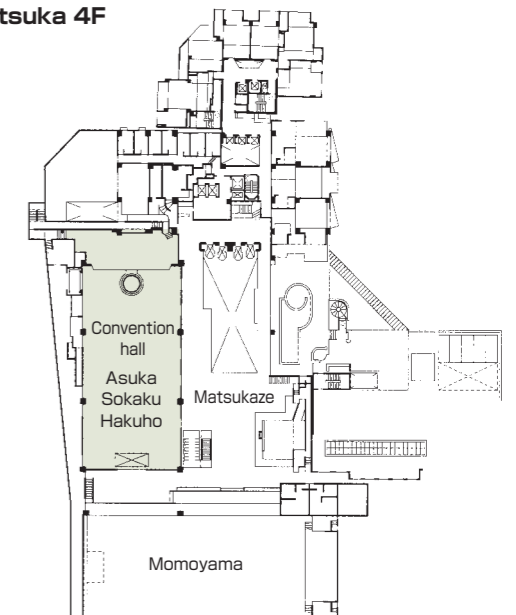

■ Convention site

Site name	Floor	Area(m ²)	Width × Depth (m)	Ceiling height(m)	Capacity (persons)					Remarks
					Fixed seats	School	Theater	Seated	Buffet	
Convention hall "Asuka" (entire room)	4	594	36.0 × 16.5	5.3	—	400	600	300	500	Loading lift available
Asuka	4	190	11.5 × 16.5	5.3	—	70	150	60	70	
Sokaku	4	200	12.0 × 16.5	5.3	—	100	150	60	80	
Hakuho	4	200	12.0 × 16.5	5.3	—	100	150	60	80	
Convention hall "Asuka" + "Matsukaze"	4	1,050		5.3	—	—	—	—	850	
Convention hall "Asuka" + "Matsukaze" + "Momoyama"	4	1,763		5.3	—	—	—	—	1,500	Momoyama hall: ceiling height 4m

Width × Depth and the floor area may not match depending on the shape of the room.

Nanao Sunlife Plaza

Wo-bu-38 Motofuchu-machi, Nanao 926-0021
 Culture hall: Nanao City Sports Association
 TEL: 0767-53-1160 FAX: 0767-53-3260
 Plaza annex: Yatago Community Center
 TEL: 0767-52-5240 FAX: 0767-52-5249



■ Number of seats
990 seats (Large hall)



■ Traffic access
 4 min by bus from JR Nanao Station
 (Get off at Sunlife Plaza and walk for 1 min.)
 4 min by taxi from JR Nanao Station



■ Hours
 9:00am~10:00pm
 Closed: Monday, national holidays, year-end and New Year's holidays (Dec. 29~Jan. 3)

■ Date to start accepting reservation
 Beginning of the month one year before the date of use



■ Accommodation
 None



■ Restaurants/Cafés
 None



■ Parking
260 vehicles (free)



■ Remarks
 Library included

Floor plan

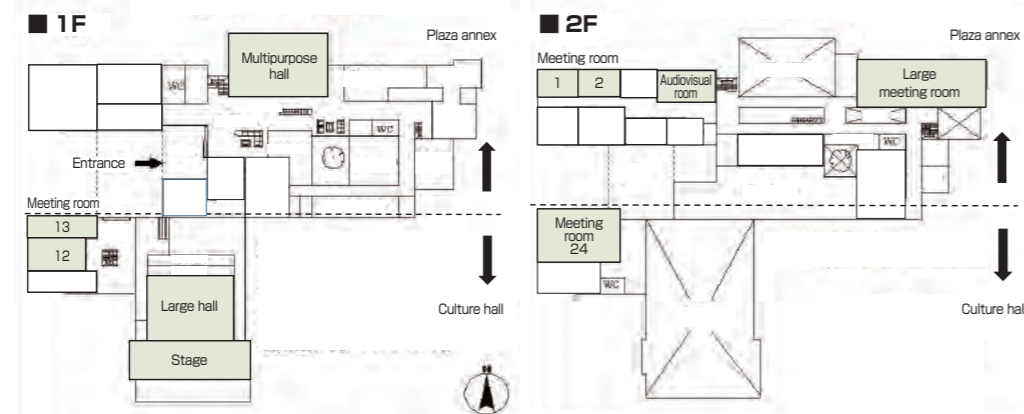

■ Convention site

Site name	Floor	Area(m ²)	Width × Depth (m)	Ceiling height(m)	Capacity (persons)					Remarks
					Fixed seats	School	Theater	Seated	Buffet	
Culture hall										
Large hall	1	-	-	7.0	990	-	-	-	-	
Meeting room 12	1	87	12.0 × 7.0	2.5	-	50	-	-	-	
Meeting room 13	1	67	7.5 × 9.5	2.5	-	30	-	-	-	
Meeting room 24	2	193	16.0 × 11.5	4.0	-	100	-	-	-	
Plaza annex										
Multipurpose hall	1	350	19.0 × 18.0	7.4	-	-	-	-	-	You can arrange the room layout freely with 50 tables and 300 chairs.
Audiovisual room	2	231	11.0 × 21.0	2.7	200	-	-	-	-	
Large meeting room	2	292	11.0 × 24.0	2.7	-	-	-	-	-	
Meeting room 1	2	57	9.0 × 6.0	2.7	-	30	-	-	-	
Meeting room 2	2	57	9.0 × 6.0	2.7	-	30	-	-	-	

Width × Depth and the floor area may not match depending on the shape of the room.

Nanao Nakajima Cultural Center Noto Engekido Theater

Jobu-9 Nakajima, Nakajima-machi, Nanao 929-2222
 TEL: 0767-66-2323 FAX: 0767-66-2326
 URL: <https://www.engekido.com>
 E-mail: engekido@nanaonet.jp

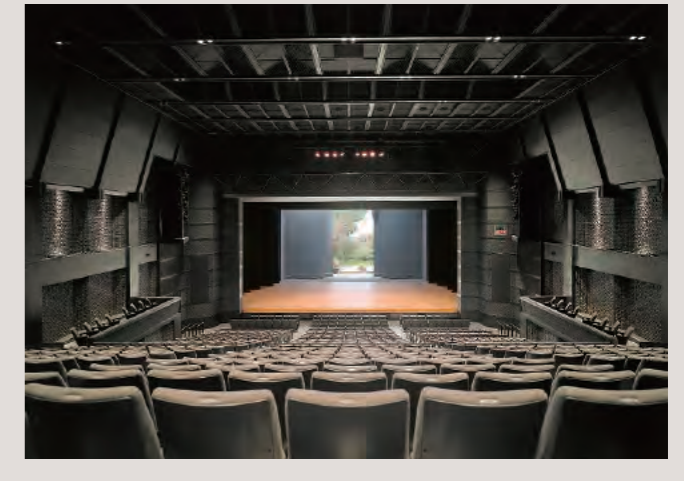

■ Number of seats
651 seats (Noto Engekido theater)



■ Traffic access
 20-min walk from Noto Nakajima Station of Noto Railway
 3-min drive from Yokota IC of Noto Satoyama Highway



■ Hours
 9:00am~10:00pm
 Closed: Monday, national holiday, year-end and New Year's holidays (Dec. 29~Jan. 3)

■ Date to start accepting reservation
 Noto Theater: One year before the date of use
 Workshop room: Three months before the date of use



■ Accommodation
 None



■ Restaurants/Cafés
 None



■ Parking
14 vehicles (free)
 The adjoining parking lot of Nanao Nakajima Community Center can be used (120 vehicles, free).



■ Remarks
 Exhibition area (museum) for past theater plays in the town

Floor plan

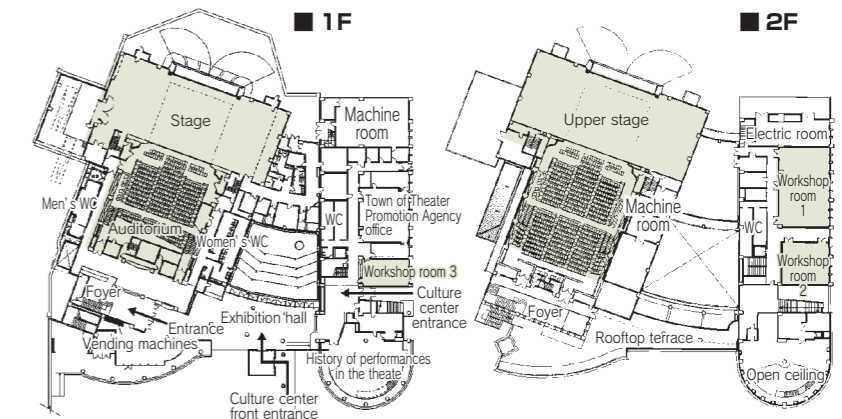

■ Convention site

Site name	Floor	Area(m ²)	Width × Depth (m)	Ceiling height(m)	Capacity (persons)					Remarks
					Fixed seats	School	Theater	Seated	Buffet	
Noto Engekido Theater	1	-	-	-	651	-	-	-	-	
Workshop room1	2	170	17.0 × 10.0	2.9	-	80	-	-	-	
Workshop room2	2	90	9.6 × 9.3	2.9	-	30	-	-	-	
Workshop room3	1	58	5.8 × 10.0	2.9	-	15	-	-	-	

Width × Depth and the floor area may not match depending on the shape of the room.

Notoraku

1-14 Kashima, Ishizaki-machi, Nanao 926-0178
 TEL: 0767-62-3131 FAX: 0767-62-3842
 URL: <http://www.notoraku.co.jp/>
 E-mail: front@notoraku.co.jp



Floor plan

■ 2F

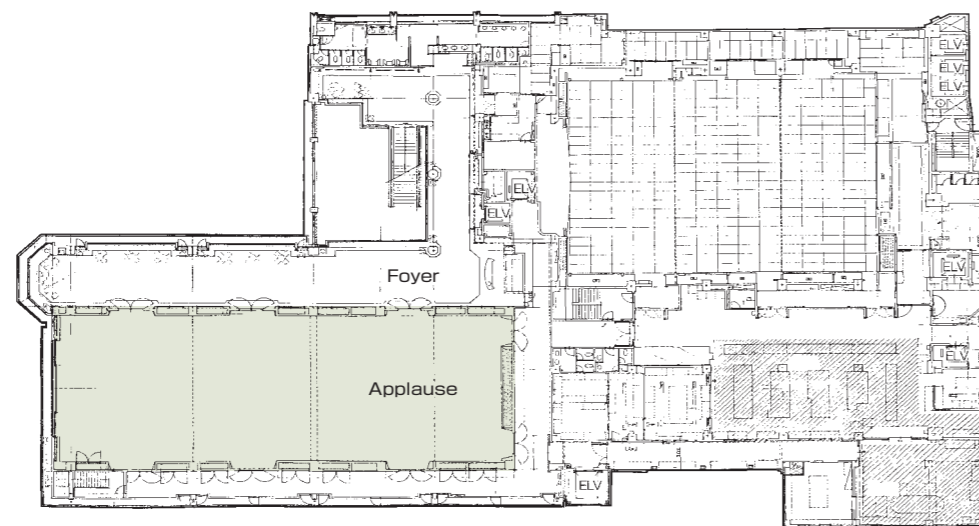

■ Number of seats
500 seats (Applause)



■ Traffic access
 5 min by bus from JR Wakura Onsen Station
 Free pickup bus (reservation required)



■ Hours
 9:00am~10:00pm



■ Accommodation
 171 rooms: 650 people



■ Restaurants/Cafés
 ・ Karaoke lounge "London Club": 80 seats
 ・ Lobby lounge "Marco Polo": 32 seats



■ Parking
 150 vehicles (free)



■ Remarks
 None

■ Convention site

Site name	Floor	Area(m ²)	Width × Depth (m) (m)	Ceiling height(m)	Capacity (persons)					Remarks
					Fixed seats	School	Theater	Seated	Buffet	
Applause	2	550	35.0 × 14.0	7.0	-	500	700	250	600	The space can be partitioned into three rooms.

Width × Depth and the floor area may not match depending on the shape of the room.

Forum Nanao

1 Misogi-cho, Nanao 926-0811
 (4F and 5F of Patria Bldg.)
 TEL: 0767-52-5222 FAX: 0767-52-5239
 URL: <https://patria.co.jp/forum-nanao/>
 E-mail: forum770@soseinanao.com



Floor plan



■ Number of seats
250 seats (Multipurpose hall)



■ Traffic access
 1 min walk from JR Nanao Station



■ Hours
 10:00am~8:30pm
 Closed: Wednesdays (when Wednesday is a national holiday, the following day will be closed too), national holidays, year-end and new year holidays (Dec.29 - Jan.3)



■ Date to start accepting reservation
 One year before the date of use



■ Accommodation
 None



■ Restaurants/Cafés
 None
 *There are restaurants on the first floor



■ Parking
 467 vehicles
 (Free for 3hrs)



■ Remarks
 ・ Wi-Fi accessible
 ・ Inside the "Patria" building in front of Nanao Station

■ 4F

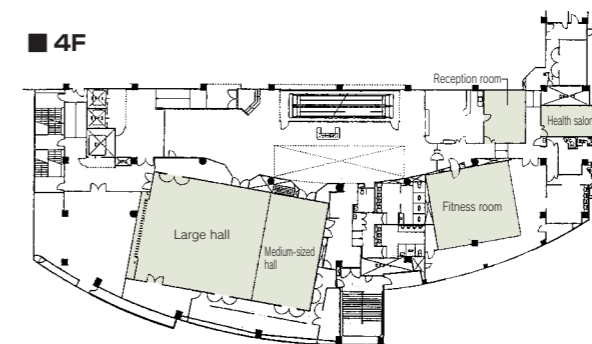

■ 5F

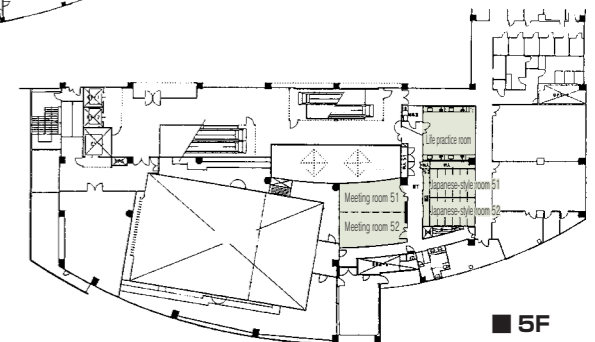

■ Convention site

Site name	Floor	Area(m ²)	Width × Depth (m) (m)	Ceiling height(m)	Capacity (persons)					Remarks
					Fixed seats	School	Theater	Seated	Buffet	
Multipurpose hall	4	273	21.0 × 13.0		-	250	-	-	-	The space can be partitioned into two rooms. (Large hall, Medium-sized hall)
Fitness room	4	190			-	30	-	-	-	
Health salon	4	28			-	10	-	-	-	
Meeting room/ reception room	4	32			-	10	-	-	-	
Meeting rooms (51, 52)	5	63			-	36	-	-	-	The space can be partitioned into two rooms.
Japanese-style rooms (51, 52)	5	50			-	40	-	-	-	The space can be partitioned into two rooms.
Life practice room	5	42			-	20	-	-	-	Cooking room

Width × Depth and the floor area may not match depending on the shape of the room.

Yadomoriya Jyuen

2-52 Hibari, Wakura-machi, Nanao 926-0176
 TEL: 0767-62-3322 FAX: 0767-62-4818
 URL: <https://www.yadojuen.co.jp/>
 E-mail: info@yadojuen.co.jp



Multipurpose hall

Floor plan

■ 1F

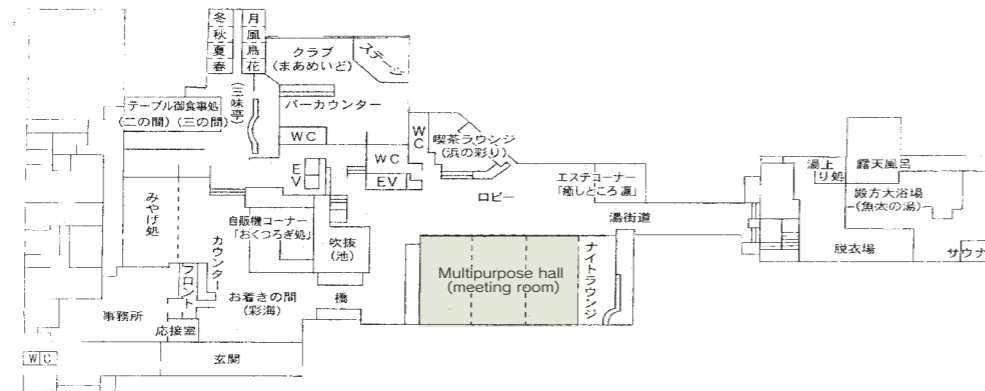

■ Number of seats
220 seats (Theater-style)



■ Traffic access
 5 min by bus from JR Wakura Onsen Station
 Free pickup car is available (reservation required)



■ Hours
 9:00am~10:00pm

■ Date to start accepting reservation
 One year before the date of use



■ Accommodation
 59 rooms (300 people)



■ Restaurants/Cafés
 ・Lounge "Mermaid": 50 seats
 ・Coffee shop "Hama-no-Irodori": 40 seats



■ Parking
 50 vehicles (free)



■ Remarks
 None

■ Convention site

Site name	Floor	Area(m ²)	Width × Depth (m)	Ceiling height(m)	Capacity (persons)					Remarks
					Fixed seats	School	Theater	Seated	Buffet	
Multipurpose hall (meeting room)	1	216	12 × 18	3		200	220	100	100	Can be partitioned into three areas

Width × Depth and the floor area may not match depending on the shape of the room.

Wakura Onsen Omatsuri Hall

2-13-1 Wakura-machi, Nanao 926-0175
 TEL: 0767-62-4332 FAX: 0767-62-0901



Large meeting room

Floor plan

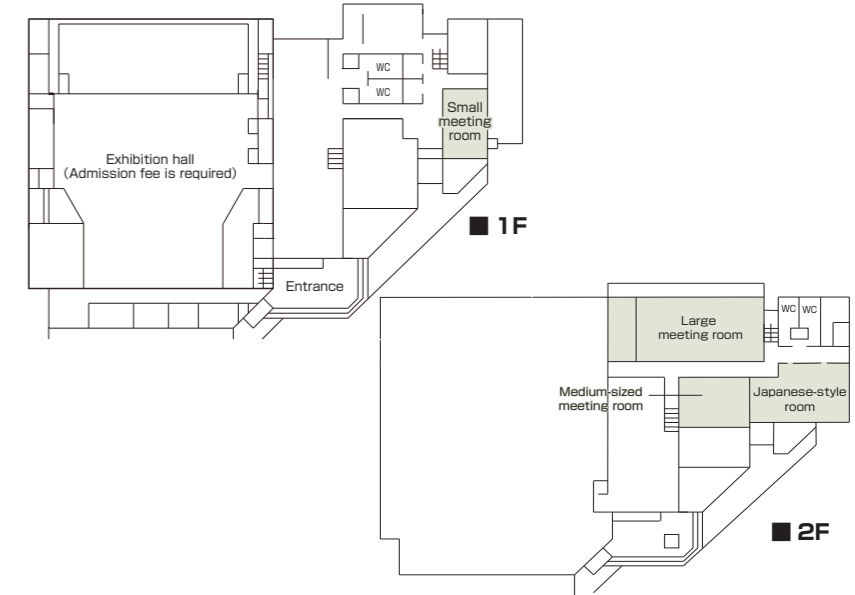

■ Number of seats
150 seats (Large meeting room)



■ Traffic access
 5 min by bus from JR Wakura Onsen Station (Get off at Wakura Onsen Omatsuri kaikan-mae)
 5 min by taxi from JR Wakura Onsen Station
 20-min walk from JR Wakura Onsen Station
 5-min drive from Wakura IC of Nanao Tatsuruhama Bypass (Get off Noto Satoyama Highway at Tokuda Otsu JCT, take Tatsuruham Highway (Nanao City) and the Bypass).



■ Hours
 9:00am~5:00pm

Note:
 The hall may be closed temporarily due to equipment inspection or repair.

■ Date to start accepting reservation
 Seven days before the date of use



■ Accommodation
 None



■ Restaurants/Cafés
 Souvenir area (No restaurant)



■ Parking
 94 vehicles (incl. 5 large vehicles)



■ Remarks
 AED

■ Convention site

Site name	Floor	Area(m ²)	Width × Depth (m)	Ceiling height(m)	Capacity (persons)					Remarks
					Fixed seats	School	Theater	Seated	Buffet	
Large meeting room	2	190	22 × 10	3.1	—	100	150	—	—	With a simple stage, screen, partitions for dividing the space into two rooms
Japanese-style room	2	60-tatami-mat	16 × 7.5	2.7	—	40	80	—	—	Floor cushion and low table The space can be partitioned into two rooms.
Medium-sized meeting room	2	82.5	11 × 7.5	2.7	—	20	40	—	—	The space can be partitioned into two rooms.
Small meeting room	1	70	10 × 7	2.7	14	—	—	—	—	Table layout is fixed.

Width × Depth and the floor area may not match depending on the shape of the room.

National Tangible Cultural Property Traditional house, Mioya-no-sato

Mu-103 Kodanaka, Nakanoto-machi, Kashima
929-1632
TEL: 0767-74-2806 FAX: 0767-74-1300
URL: https://www.town.nakanoto.ishikawa.jp/life_service_local/3/1/2354.html



Floor plan

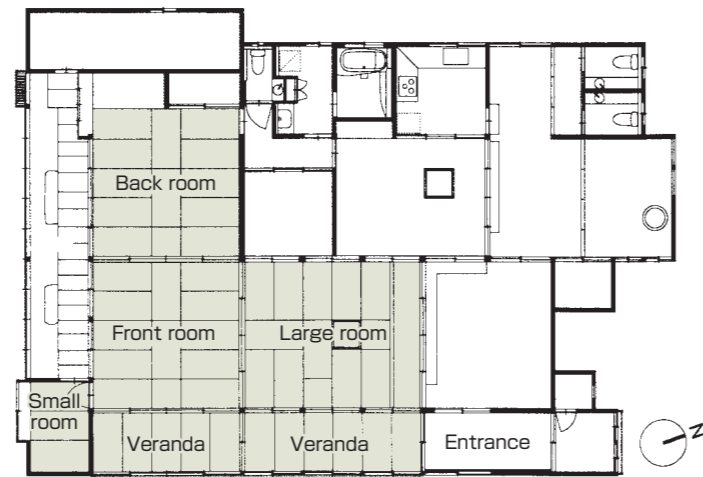

Site name	Floor	Area(m ²)	Width × Depth (m)	Ceiling height(m)	Capacity (persons)					Remarks
					Fixed seats	School	Theater	Seated	Buffet	
Large room	—	20.7	3.9 × 4.3	5.0	20	—	—	—	—	
Front room	—	20.7	3.9 × 3.6	3.0	20	—	—	—	—	
Back room	—	20.7	3.6 × 3.6	3.0	20	—	—	—	—	
Veranda	—	9.9	2.2 × 4.0	2.5	10	—	—	—	—	
Veranda	—	9.9	2.2 × 4.0	2.5	10	—	—	—	—	
Small room	—	5.0	1.6 × 1.8	2.0	5	—	—	—	—	

Width × Depth and the floor area may not match depending on the shape of the room.

Iko no Mura Noto Hanto

Shikanosato Onsen, Shika-machi, Hakui 925-0165
TEL: 0767-32-3131 FAX: 0767-32-3134
URL: <http://www.noto-ikoinomura.com>
E-mail: info@noto-ikoinomura.com



Floor plan

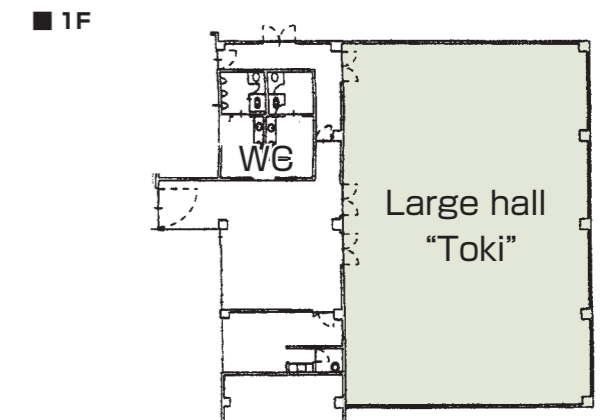

- Number of seats
200 seats (Large hall "Toki")
- Traffic access
25 min by bus from JR Hakui Station
(Get off at Takahama bus terminal and take a taxi (5 min).)
You can call for a pickup bus.
- Hours
9:00am~9:00pm
- Date to start accepting reservation
Six months before the date of use
- Accommodation
185 people, 42 guest rooms (with TV, refrigerator, washroom and Wi-Fi)
- Restaurants/Cafés
· Large banquet room (1 room) : 160-tatami-mat
· Medium-sized banquet hall (3 rooms): 27~ 65-tatami-mat
· Restaurant "Hana" (1 room): 110 seats
· Barbeque salon: 100 seats
· Snack "Nova": 40 seats
· Private restaurant "Hyakka": 9 rooms
- Parking
200 vehicles (free)
- Remarks
Wi-Fi is accessible in large halls "Toki" and "Shika".

Site name	Floor	Area(m ²)	Width × Depth (m)	Ceiling height(m)	Capacity (persons)					Remarks
					Fixed seats	School	Theater	Seated	Buffet	
Large hall "Toki"	1	282	20.7 × 13.6	3.6	—	200	—	120	150	
Shika	1	212	18.3 × 11.6	3.0	—	100	—	90	110	
Takahama	1	89	14.7 × 6.1	2.9	—	50	—	—	—	
Hakui	2	166	19.1 × 8.7	3.2	—	80	—	70	90	

Width × Depth and the floor area may not match depending on the shape of the room.



■ Number of seats
85 seats



■ Traffic access
20-min drive from Yanagida IC of Noto Satoyama Highway
8 min by taxi from JR Notobe Station
1-min walk from Kodanaka bus stop of Hokuriku Railroad Noto Bus



■ Hours
9:00am~10:00pm

■ Date to start accepting reservation



■ Accommodation
None



■ Restaurants/Cafés
None
* We will provide information about catering service if necessary.



■ Parking
15 vehicles (free)



■ Remarks
Reservation required

■ Convention site

Site name	Floor	Area(m ²)	Width × Depth (m)	Ceiling height(m)	Capacity (persons)					Remarks
					Fixed seats	School	Theater	Seated	Buffet	
Large room	—	20.7	3.9 × 4.3	5.0	20	—	—	—	—	
Front room	—	20.7	3.9 × 3.6	3.0	20	—	—	—	—	
Back room	—	20.7	3.6 × 3.6	3.0	20	—	—	—	—	
Veranda	—	9.9	2.2 × 4.0	2.5	10	—	—	—	—	
Veranda	—	9.9	2.2 × 4.0	2.5	10	—	—	—	—	
Small room	—	5.0	1.6 × 1.8	2.0	5	—	—	—	—	

Width × Depth and the floor area may not match depending on the shape of the room.

Shika Town Togi Regional Development Center

Kou-10 Togiryoke-machi, Shika-machi, Hakui 925-0498
TEL: 0767-42-0500 FAX: 0767-42-2858



■ Number of seats
530 seats (Large hall)



■ Traffic access
63 min by bus from JR Hakui Station (Express bus: 55 min) (Get off at Togi Bus Terminal and walk for 10 min.)



■ Hours
9:00am~10:00pm
Closed: Year-end and New Year's holidays (Dec. 29~Jan. 3)

■ Date to start accepting reservation
From one month to seven days before the date of use



■ Accommodation
None



■ Restaurants/Cafés
None



■ Parking
211 vehicles (free)



■ Remarks
Town office and library co-located

Floor plan

■ 1F

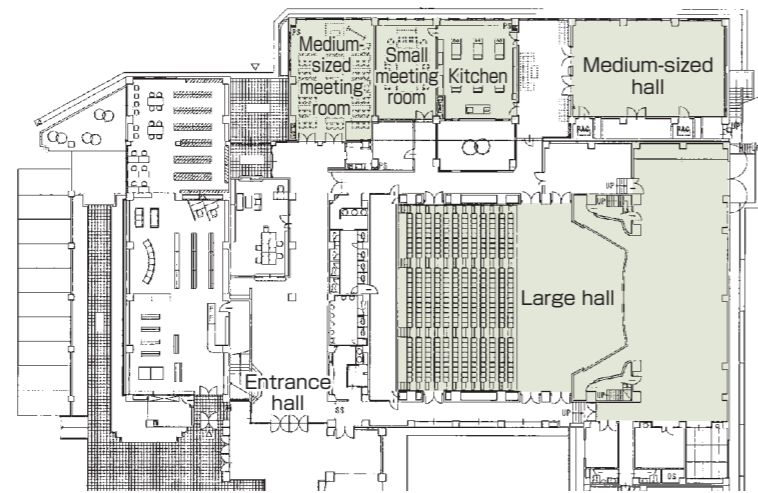

■ Convention site

Site name	Floor	Area(m ²)	Width × Depth (m)	Ceiling height(m)	Capacity (persons)					Remarks
					Fixed seats	School	Theater	Seated	Buffet	
Large hall	1	365	-	-	-	-	530	-	-	390 movable seats, 320-inch (16:9) electric screen
Medium-sized hall	1			4.7	-	90	154	-	-	120-inch (4:3) electric screen
Medium-sized meeting room	1			3.0	-	63	-	-	-	100-inch (4:3) electric screen
Small meeting room	1			3.0	18	-	-	-	-	
Kitchen	1			3.0	-	-	-	-	-	Cooking counters: 6 (with IH cookers)
Workshop room 1 (Japanese-style)	2	12-tatami-mat	3.3 × 6.2	2.7	-	-	-	-	-	
Workshop room 2 (Japanese-style)	2	12-tatami-mat	3.3 × 6.2	2.7	-	-	-	-	-	
Workshop room 4 (Japanese-style)	2	12-tatami-mat	9.6 × 5.0	2.7	-	-	-	-	-	

Width × Depth and the floor area may not match depending on the shape of the room.

Royal Hotel Noto

Ra-1 Yaguradani, Shika-machi, Hakui 925-0156
TEL: 0767-32-3111 FAX: 0767-32-3120
URL: <https://www.daiwaresort.jp/noto/>
E-mail: noto@daiwaresort.co.jp



■ Number of seats
600 seats (Royal Hall)



■ Traffic access
75 min by express bus from JR Kanazawa Station (Get off at Takahama and take a taxi (5min).)
25 min by taxi from Hakui Station of JR Nanao Line.
50 min by taxi from Noto Satoyama Airport
110 min by taxi from Komatsu Airport



■ Hours
8:00am~10:00pm
Open year-round

■ Date to start accepting reservation
At any time



■ Accommodation
• Western-style room (capacity: 4): 167
• Japanese-style room (capacity: 4): 38
• Other room: 29
Total: 234 rooms, 571 people



■ Restaurants/Cafés
• Restaurant "Sakura": 120 seats
• Japanese restaurant "Ajinoren": 40 seats
• Karaoke pub "Muse": 50 seats



■ Parking
300 vehicles (free)



■ Remarks
None

Floor plan

■ 2F

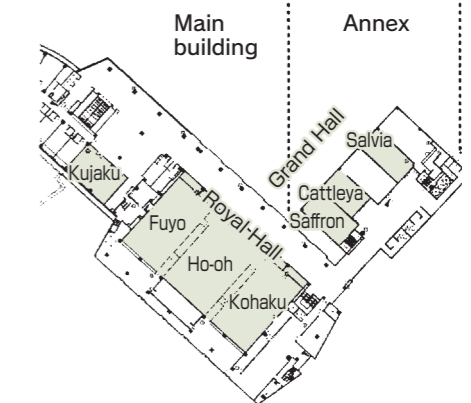

■ Convention site

Site name	Floor	Area(m ²)	Width × Depth (m)	Ceiling height(m)	Capacity (persons)					Remarks
					Fixed seats	School	Theater	Seated	Buffet	
Royal Hall	2	1,015	21.2 × 42.0	5.6	-	600	1,300	600	1,050	The space can be partitioned into three rooms.
Fuyo	2	340	21.2 × $\frac{11.6}{13.6}$	5.6	-	200	350	200	350	
Ho-oh	2	340	21.2 × 14.2	5.6	-	200	500	200	350	With a stage
Kohaku	2	340	21.2 × $\frac{11.9}{14.0}$	5.6	-	200	350	200	350	
Grand Hall	2	187	13.8 × 7.5	2.6	-	85	140	85	130	The space can be partitioned into two rooms.
Saffron	2	102	13.8 × 7.3	2.6	-	50	80	50	80	
Cattleya	2	85	10.8 × 7.5	2.6	-	35	60	35	50	
Salvia	2	95	13.7 × 6.9	2.6	-	50	80	40	70	
Kujaku	2	40	13.5 × 8.6	3.0	-	32	50	24	50	The space can be partitioned into two rooms.

Width × Depth and the floor area may not match depending on the shape of the room.

Space Science Museum Cosmo Isle Hakui

25 Menda, Tsuruta-machi, Hakui 925-0027
 TEL: 0767-22-9888 FAX: 0767-22-1947
 URL: <http://www.hakui.ne.jp/ufo/>



Large hall "Euphony Hall"

Floor plan

■ 1F

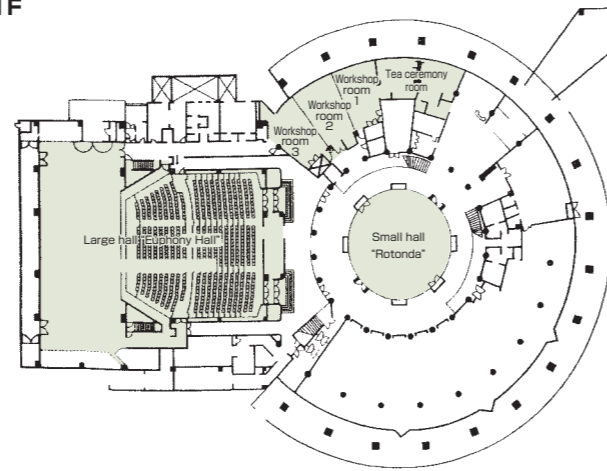

■ Number of seats
896 seats (Large hall "Euphony Hall")



■ Traffic access
 8-min walk from JR Hakui Station East Exit
 Near the Gokokudaka intersection on Route 286



■ Hours
 Rental facility: 9:00am~10:00pm
 Space science museum: 8:30am~5:00pm

■ Date to start accepting reservation
 Large hall: One year before the date of use
 Other hall and rooms: Six months before the date of use



■ Accommodation
 None



■ Restaurants/Cafés
 Snack, coffee and drinks are served at the museum shop.



■ Parking
250 vehicles (incl. 6 large vehicles) (free)



■ Remarks
 A grand piano, Bösendorfer Imperial (Model 290) is provided.
 Parent and child seats: 12
 Proscenium type hall with good acoustics
 The stage has large wings and can be used for various types of performance such as folk dance or piano recitals.
 This facility, located halfway between Kanazawa and Noto, can be used before or after staying in Wakura or Wajima.

■ Convention site

Site name	Floor	Area(m ²)	Width × Depth (m)	Ceiling height(m)	Capacity (persons)					Remarks
					Fixed seats	School	Theater	Seated	Buffet	
Large hall "Euphony Hall"	1	468	Width 15.8	8.0	896	-	-	-	-	
Small hall "Rotonda"	1	241	Diameter 17.0	8.0	-	-	250	-	-	
Workshop room	1	186	Width 1.6	3.3	-	75	-	-	-	The space can be partitioned into three rooms.
Tea ceremony room	1	85	Width 1.7	2.4	-	-	-	-	-	

Width × Depth and the floor area may not match depending on the shape of the room.

AMANDAN VILLA

Tora-25 Hachibuse, Kahoku 929-1117
 TEL: 076-283-7799 FAX: 076-283-7798
 URL: <http://restaurant.novarese.co.jp/avl>
 E-mail: r-avl@novarese.co.jp



Main dining

Floor plan



■ Number of seats
100 seats (Main dining)



■ Traffic access
 5-min drive from Unoke Station of JR Nanao Line.



■ Hours
 Please consult us about your event.

■ Date to start accepting reservation
 Please consult us about your event.



■ Accommodation
 None



■ Restaurants/Cafés
 Available



■ Parking
70 vehicles



■ Remarks

■ Convention site

Site name	Floor	Area(m ²)	Width × Depth (m)	Ceiling height(m)	Capacity (persons)					Remarks
					Fixed seats	School	Theater	Seated	Buffet	
Main dining	1	201.3	11.5 × 17.5	8.5	-	100	100	120	200	
Private room	1	46.1		2.8	-	-	-	12	-	
Crystal Hall	1	126		4.5	-	80	-	-	-	
Lounge	1	181.9		8	-	-	-	30	50	

Width × Depth and the floor area may not match depending on the shape of the room.

Ishikawa NISHIDA KITARO Museum of Philosophy

i-1 Uchihisumi, Kahoku 929-1126
 TEL: 076-283-6600 FAX: 076-283-6320
 URL: <http://www.nishidatetsugakukan.org/>
 E-mail: nishida-museum@city.kahoku.lg.jp

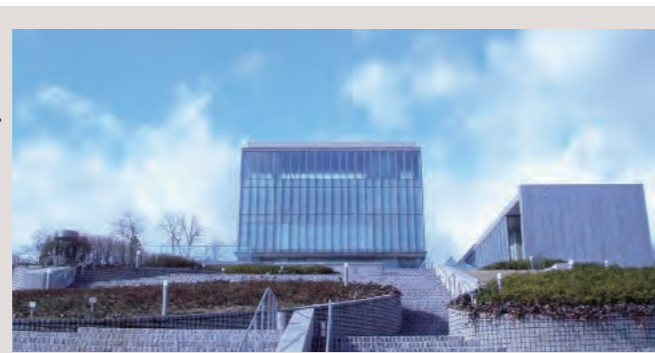

Floor plan

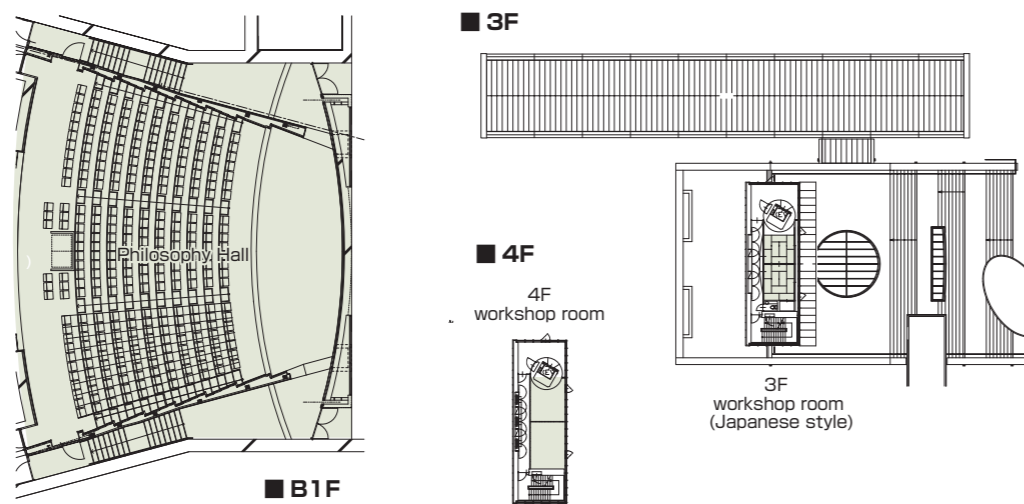

Number of seats
303 seats (Hall)



Traffic access
 20-min walk from Unoke Station of JR Nanao Line
 20-min drive from Kanazawa-higashi IC of Hokuriku Expressway
 5-min drive from Shiroo IC of Noto Satoyama Highway



Hours
 9:00am~10:00pm
 Closed: Monday (the following weekday when Monday is a holiday), year-end and New Year's holidays and maintenance period

Date to start accepting reservation
 From three months to 10 days before the date of use



Accommodation
 None



Restaurants/Cafés
 Coffee shop "Teoria":
 14 seats



Parking
 65 vehicles



Remarks
 None

Convention site

Site name	Floor	Area(m ²)	Width × Depth (m)	Ceiling height(m)	Capacity (persons)				Remarks
					Fixed seats	School	Theater	Seated	
Philosophy Hall	B1	302		5	303				Stage: 62m ² , Auditorium: 240m ²
4F workshop room	4	55		2.5					Tables and chairs (40 chairs)
3F workshop room (Japanese style)	3	40		2.5					

Width × Depth and the floor area may not match depending on the shape of the room.

Tsubata Town Cultural Center "CYGNUS"

3-1 Kita-chujo, Tsubata-machi, Kahoku 929-0342
 TEL: 076-288-8526 FAX: 076-288-8527
 URL: <http://www.town.tsubata.ishikawa.jp/shisetsu/cygnus/>
 E-mail: shougaiyouiku@town.tsubata.lg.jp

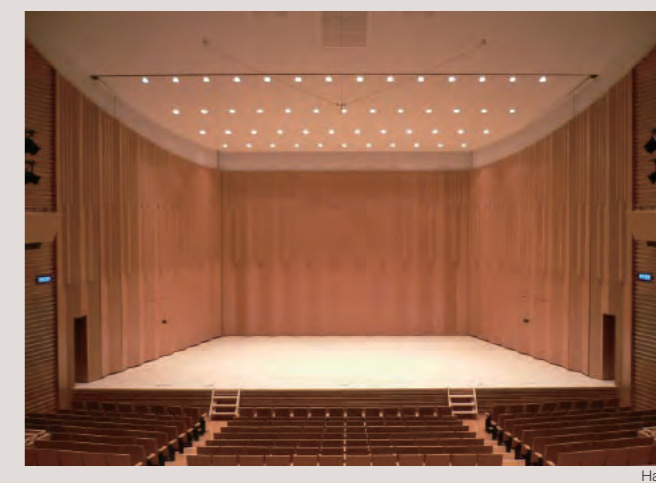

Floor plan

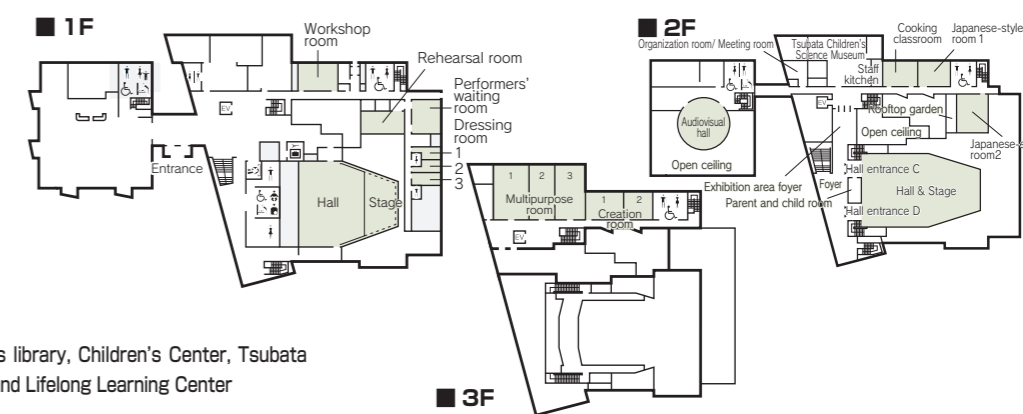

Number of seats
802 seats (Hall)
 (Fixed seat: 784, Wheelchair space: 12, Parent and child seat: 6)



Traffic access
 10 min walk from Tsubata Station of Ishikawa Railway and JR Nanao Line
 10 min drive from Kanazawa-higashi IC of Hokuriku Expressway



Hours
 9:00am~ 9:30pm
 Closed: Monday (the following weekday when Monday is a holiday), year-end and New Year's holidays (Dec. 28~Jan. 4)

Date to start accepting reservation
 Hall: One year before the date of use
 Rehearsal room or performer's waiting room only: One month before the date of use
 Other rooms: Beginning of the month three months before the date of use



Accommodation
 None



Restaurants/Cafés
 Coffee shop "Cygnus":
 14 seats



Parking
 180 vehicles (free)



Remarks
 Complex including the town's library, Children's Center, Tsubata Children's Science Museum and Lifelong Learning Center

Convention site

Site name	Floor	Area(m ²)	Width × Depth (m)	Ceiling height(m)	Capacity (persons)				Remarks	
					Fixed seats	School	Theater	Seated		Buffet
Hall	1,2		17.6 × 10.2	10.8	784	—	—	—	Wheelchair space: 12, Parent and child room: 6	
Audiovisual hall	2	76	15 × 15	7	150	150	150	—	With a small stage, a projector, acoustic system and a lectern	
Dressing room1	1	13	2.6 × 5	2.8	—	—	6	6	Western-style room	
Dressing room2	1	13	2.6 × 5	2.8	—	—	6	6	Western-style room	
Dressing room3	1	13	2.6 × 5	2.8	—	—	6	6	Japanese-style room with shower	
Rehearsal room	1	83	7.5 × 11	2.8	—	36	60	36	Noise insulation, upright piano, acoustic system	
Performers' waiting room	1	75	7 × 11	6	—	30	60	30	Two mirror walls (with handrail), upright piano, acoustic system	
Workshop room	1	76	7.5 × 10	2.8	—	30	50	30	Provided with a projector	
Japanese-style room 1	2	50	4.5 × 11	2.6	—	32	50	32	50	
Japanese-style room 2	2	50	4.5 × 11	2.5	—	20	40	20	40	Tea ceremony room with the preparation area and a Japanese garden
Cooking room	2	73	7.3 × 10	2.8	36	36	—	36	70	Gas cooking stove (6), IH cooking equipment (1), oven & microwave, rice cooker, etc.
Multipurpose room 1	3	140	9.3 × 13.6	4.8	—	60	100	60	100	Multipurpose room 1~3 can be integrated into one space. A projector and acoustic system are furnished in Multipurpose room 1.
Multipurpose room 2	3	100	6.8 × 13.6	4.8	—	60	80	60	80	
Multipurpose room 3	3	100	7.3 × 13.6	4.8	—	60	80	60	80	
Creation room 1	3	53	6.5 × 8	2.8	16	16	30	—	—	Worktable for 4 persons: 4
Creation room 2	3	53	6.5 × 8	2.8	24	24	30	—	—	Worktable for 4 persons: 6, electric furnace, potter's wheel

Width × Depth and the floor area may not match depending on the shape of the room.

Uchinada Town Cultural Center

140 Taiseidai, Uchinada-machi, Kahoku 920-0267
 TEL: 076-286-1123 FAX: 076-286-1132



Large hall



■ Number of seats
890 seats (Large hall)



■ Traffic access
 7 min by bus (for Ikadaigaku) from Uchinada Station of Asanogawa Line, Hokuriku Railroad (Get off at Taiseidai and walk for 1 min.)



■ Hours
 9:00am~10:00pm
 Closed: Monday

■ Date to start accepting reservation
 One year before the date of use



■ Accommodation
 None



■ Restaurants/Cafés
 None



■ Parking
85 vehicles (free)



■ Remarks
 None

Floor plan

■ 1F

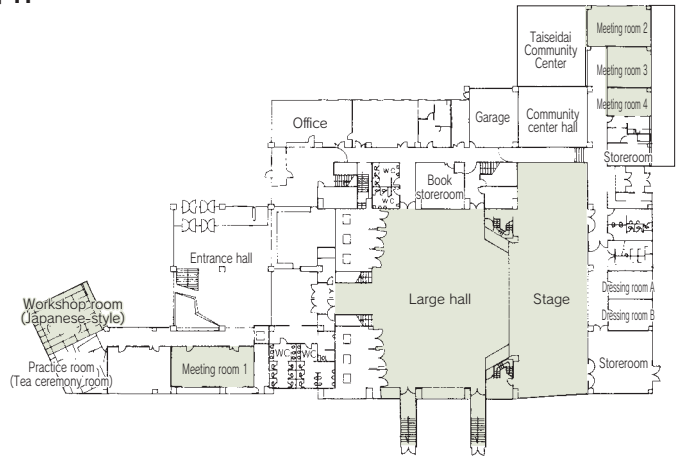

■ Convention site

Site name	Floor	Area(m ²)	Width × Depth (m)	Ceiling height(m)	Capacity (persons)					Remarks
					Fixed seats	School	Theater	Seated	Buffet	
Large hall	—	1,118		8.6	—	—	890	—	—	Fixed seats: 366, Movable seats: 524
Meeting room 1	1	57		3.1	—	30	—	—	—	
Meeting room 2	1	47			—	21	—	—	—	
Meeting room 3	1	33			—	21	—	—	—	
Meeting room 4	1	23			—	12	—	—	—	
Japanese-style workshop room	1	63		2.7	—	55	—	—	—	
Multipurpose room	3	266		2.8	—	—	200	—	—	

Width × Depth and the floor area may not match depending on the shape of the room.